

SMARTCAP®

INSTRUCTION GUIDE

FORD RANGER EDITION

2019-2022

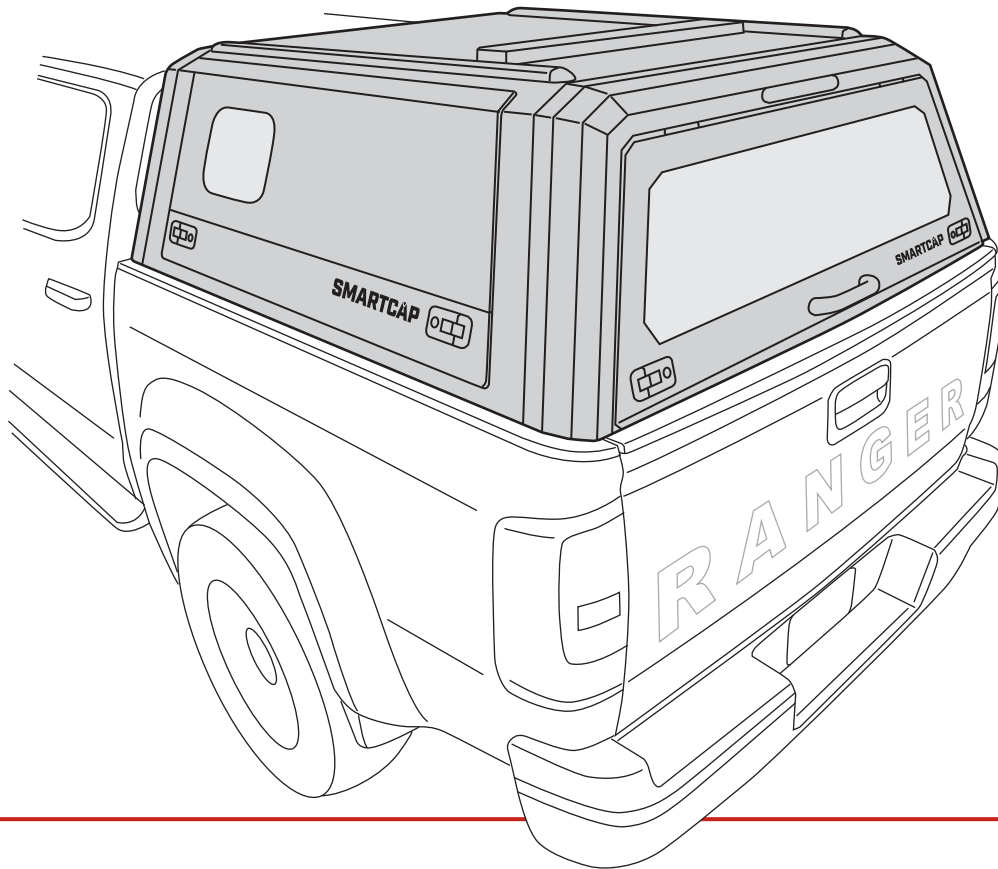

- ▼ **READ THROUGH THE ENTIRE INSTRUCTION GUIDE BEFORE STARTING THIS PROCEDURE AND FOLLOW THE STEPS CAREFULLY TO AVOID ANY DAMAGE TO THE COMPONENTS OR THE VEHICLE.**

SMARTCAP.COM - SUPPORT.NA@SMARTCAP.COM - NORTH AMERICA



P-IGUIDE-USA-R1

TOOLS REQUIRED

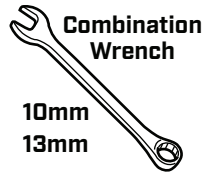
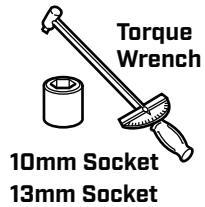
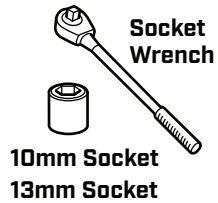

IMPORTANT

- ▼ USE ONLY THE TOOLS RECOMMENDED ABOVE.
- ▼ USE ONLY THE HARDWARE PROVIDED IN THIS KIT.
- ▼ ASSISTANCE WILL BE NEEDED FOR THIS INSTALLATION. FOUR PEOPLE ARE RECOMMENDED TO LIFT THE SMARTCAP ONTO THE VEHICLE.
- ▼ AVOID PINCHING OR CRUSHING HANDS AND FINGERS.
- ▼ INSPECT ALL KIT COMPONENTS FOR DAMAGE BEFORE ASSEMBLY.
- ▼ NEVER USE ACETONE OR THINNERS ON PAINTED PARTS.

COMPONENTS

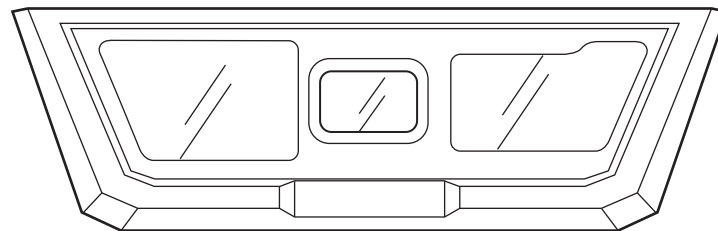

LEFT PANEL

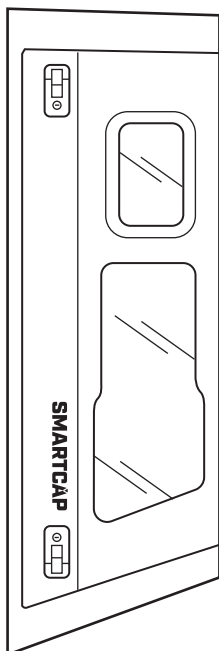

RIGHT PANEL

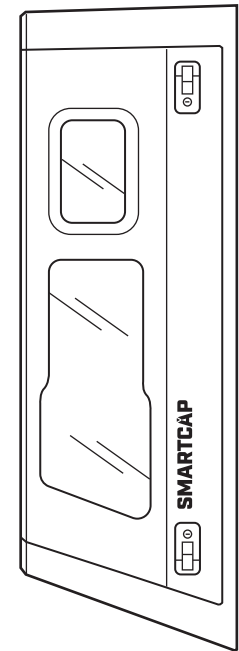

ROOF PANEL

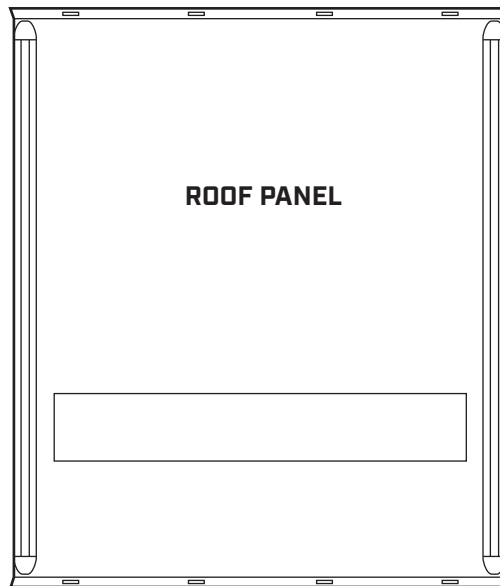

REAR FLANGE

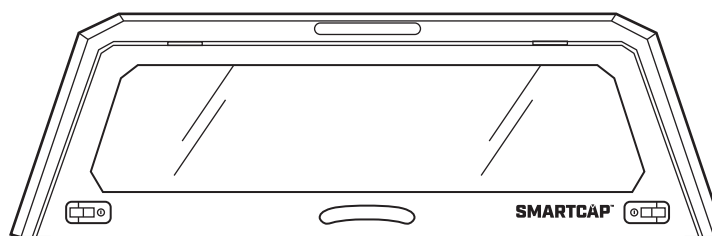

ASSEMBLY HARDWARE

[PRE-FASTENED TO FLANGES]

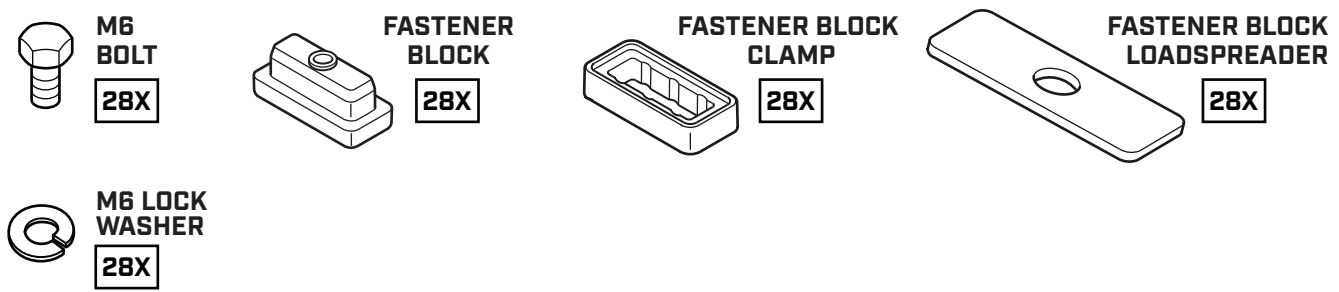

[PRE-FASTENED TO ROOF PANEL]



SPARE HARDWARE 1X

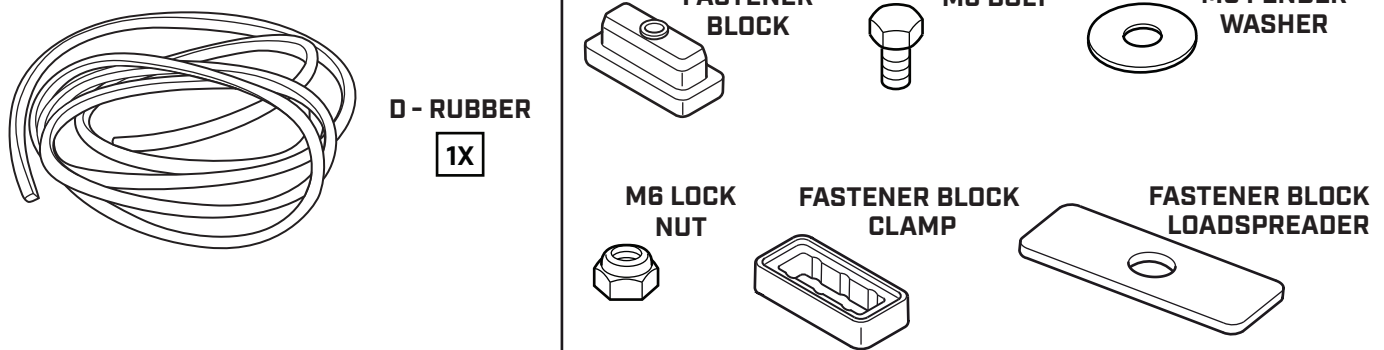

STEP 1

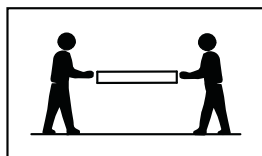

IMPORTANT

- BE SURE TO REMOVE ALL FIVE PANELS FROM THEIR PACKAGING AND INSPECT THE PAINTED SURFACES PRIOR TO ASSEMBLY, AS SMARTCAP WILL NOT ACCEPT PAINT DAMAGE WARRANTY CLAIMS AFTER ASSEMBLY IS COMPLETED. IF MANUFACTURING IMPERFECTIONS OR SHIPPING DAMAGES ARE FOUND DO NOT CONTINUE WITH THE ASSEMBLY PROCESS AND CONTACT SUPPORT.NA@SMARTCAP.COM.

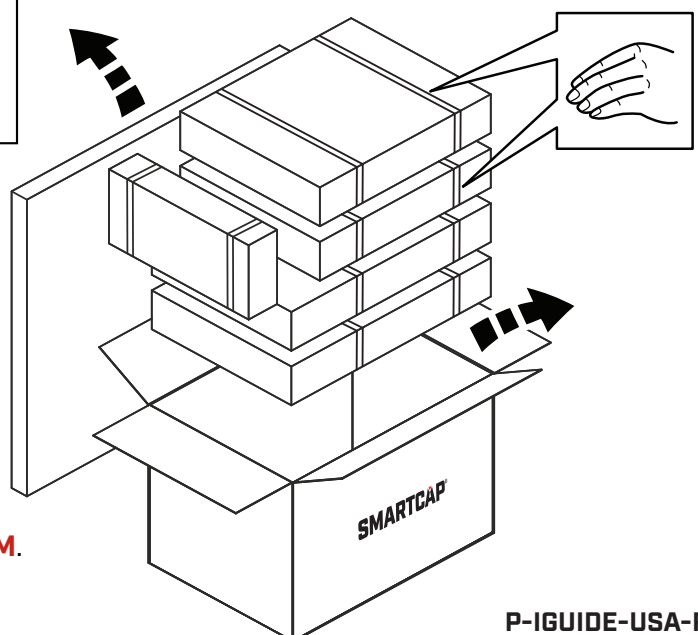

STEP 2

REMOVE ALL HARDWARE FROM ROOF PANEL



THIS SIDE UP
ROOF
PANEL

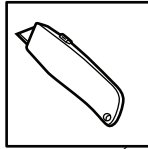
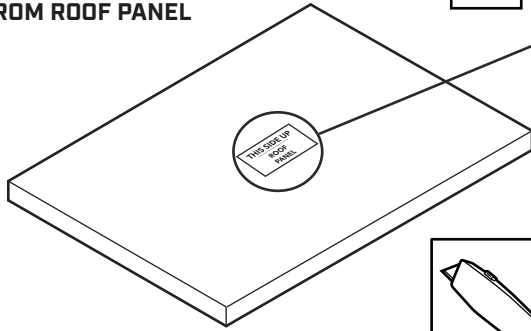

(USE THE CARDBOARD AS A WORK SURFACE)

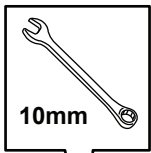

10mm

M6
LOCK NUT

M6
FENDER
WASHER

10X SHORT BED
12X STANDARD BED

ROOF PANEL

STEP 3

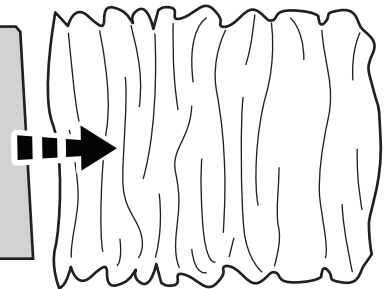
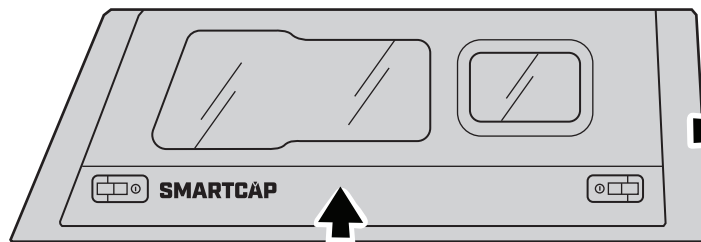

RIGHT PANEL

STEP 4

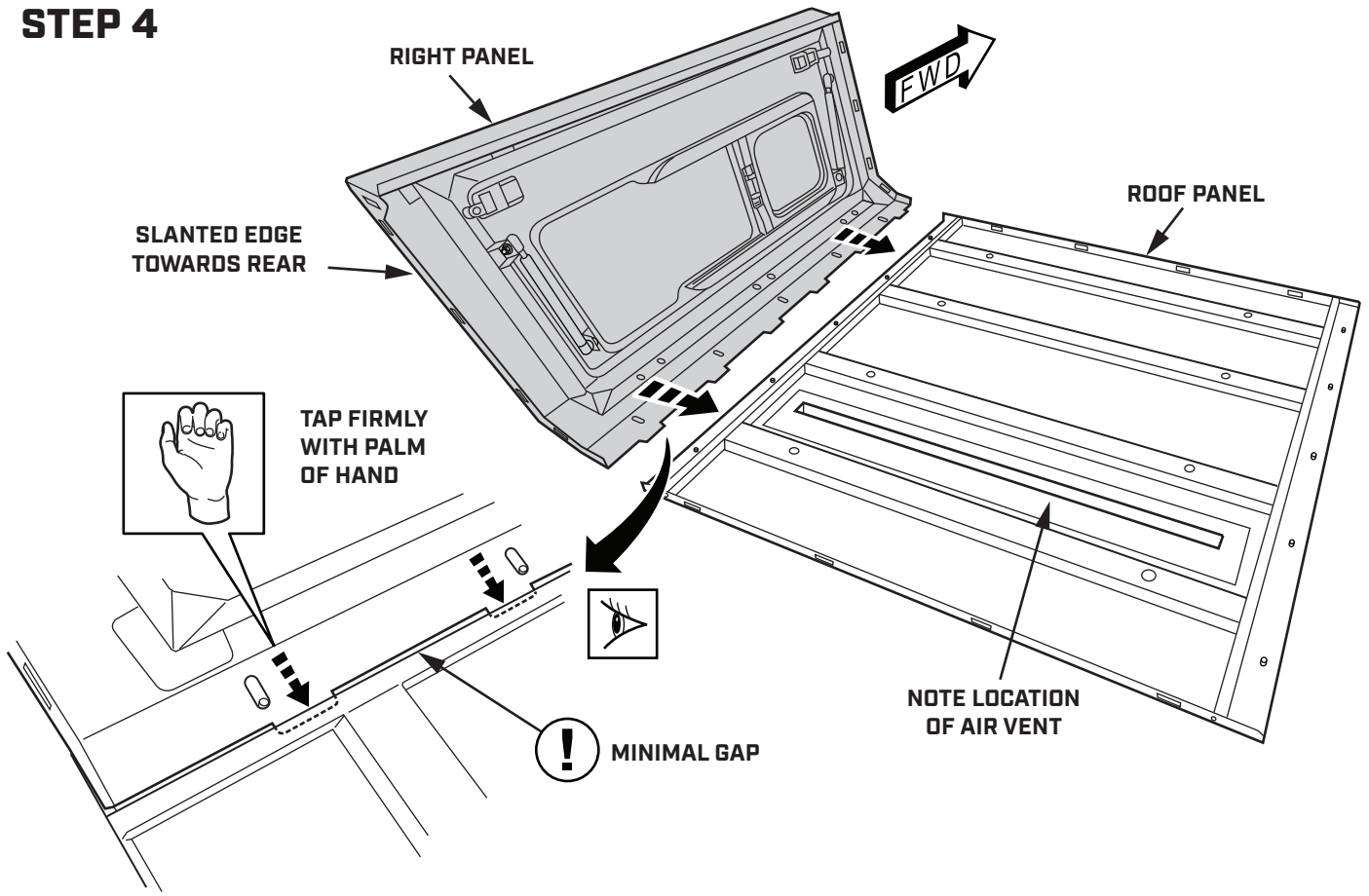

STEP 5

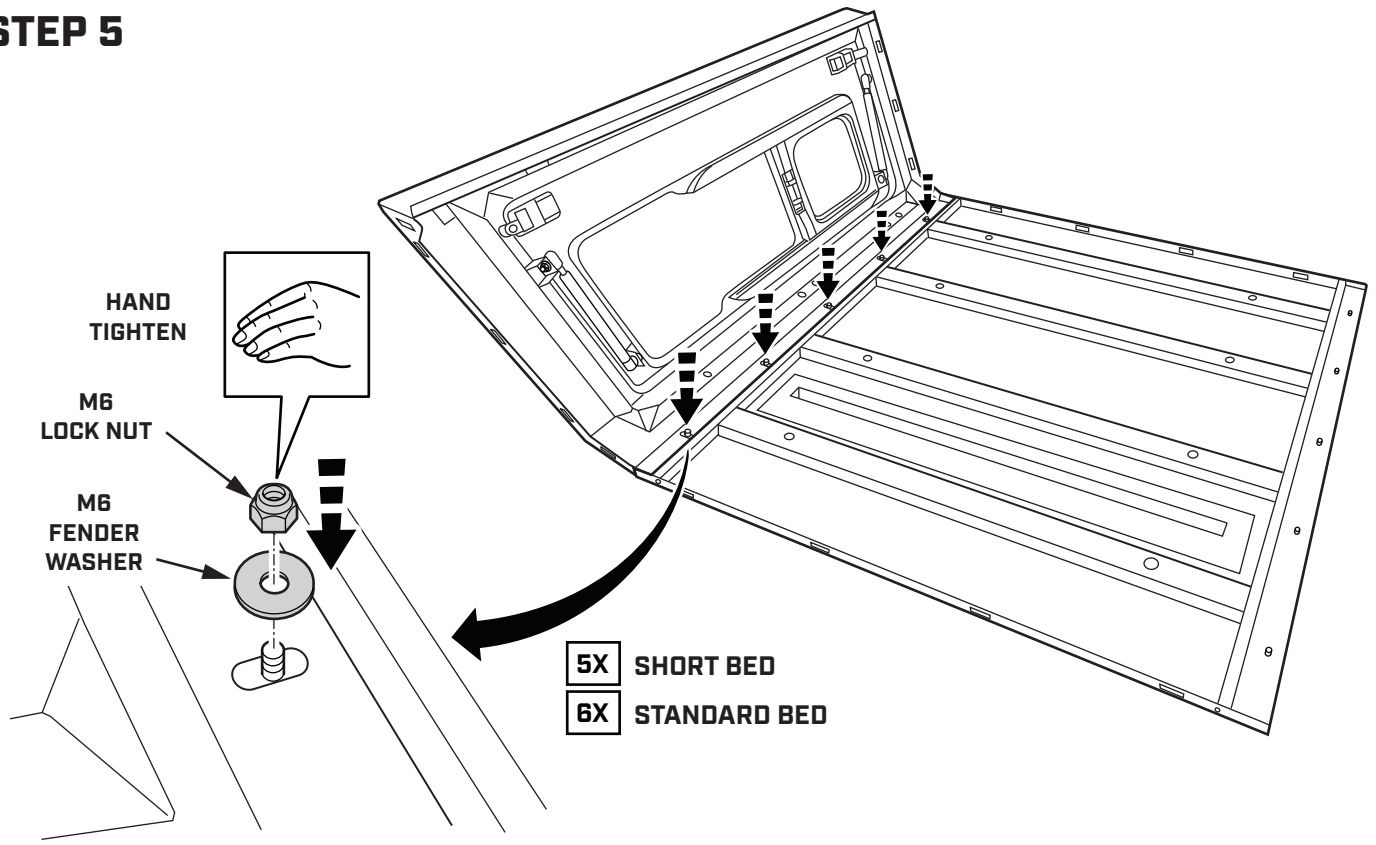

STEP 6

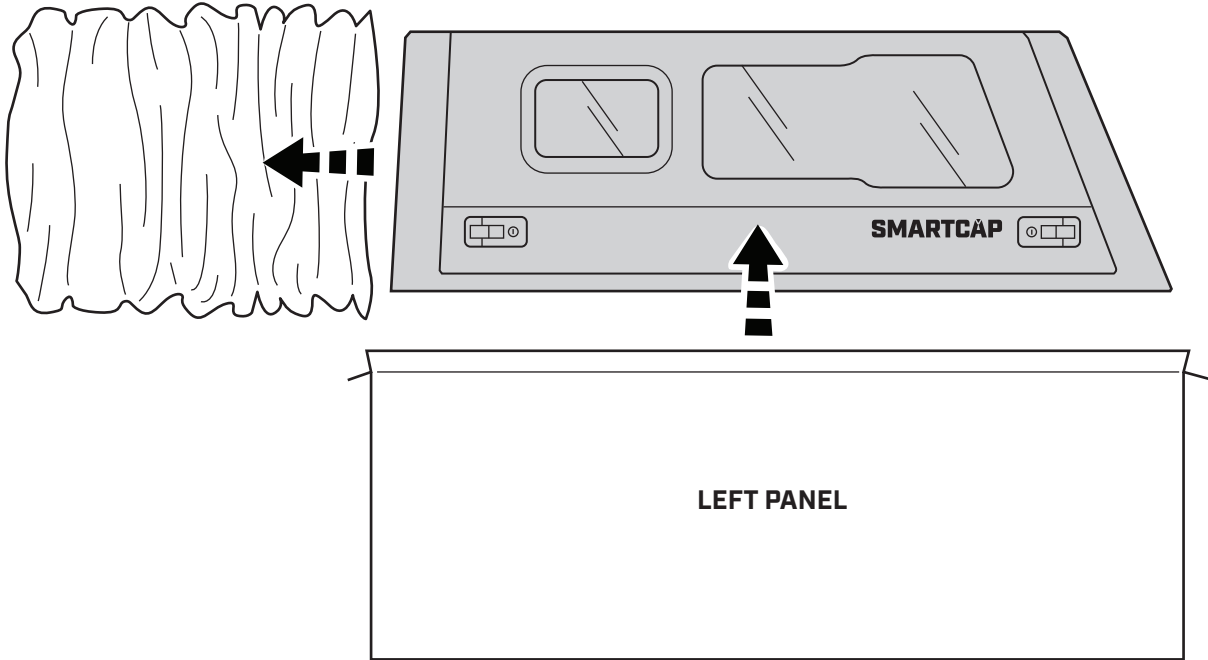
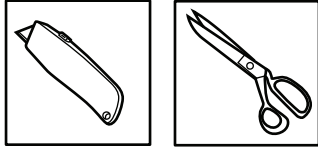

STEP 7

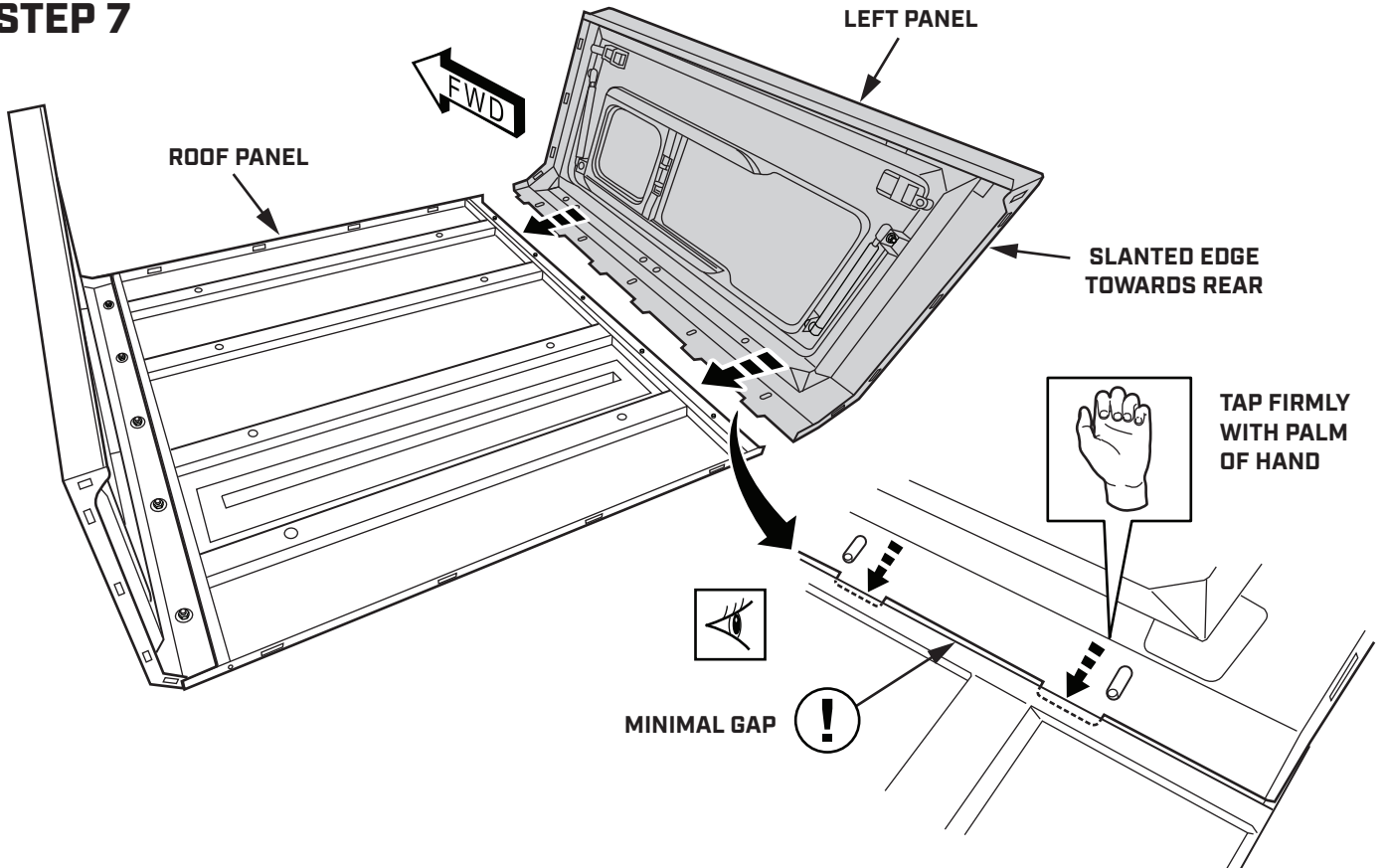

STEP 8

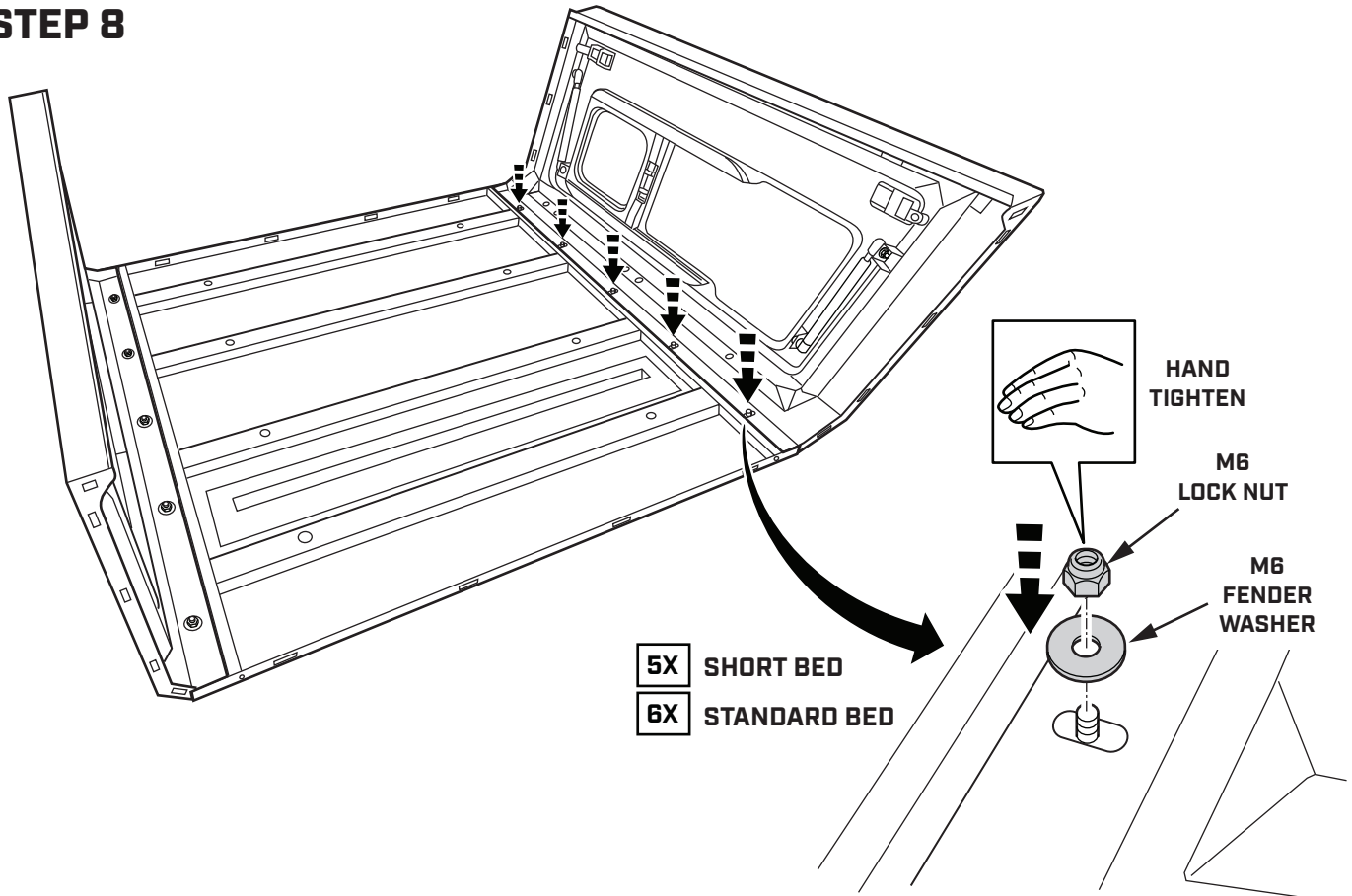

STEP 9

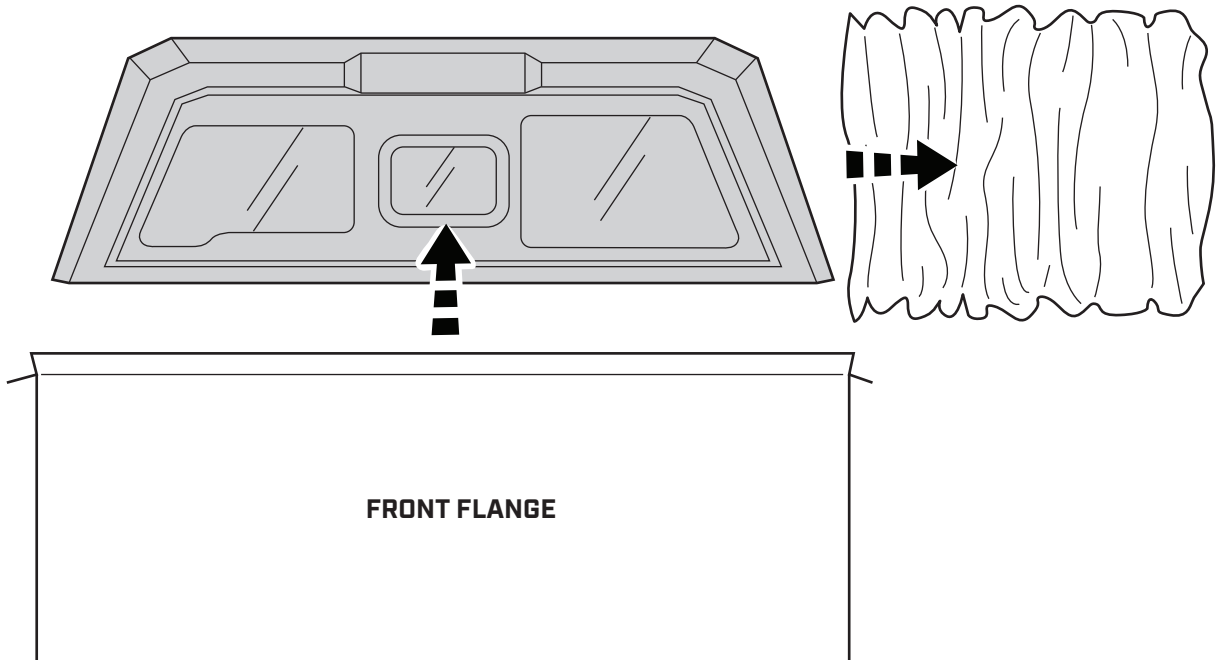
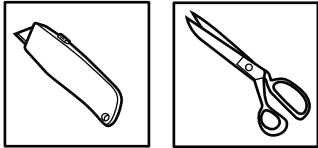

STEP 10

REMOVE ALL HARDWARE FROM FRONT FLANGE

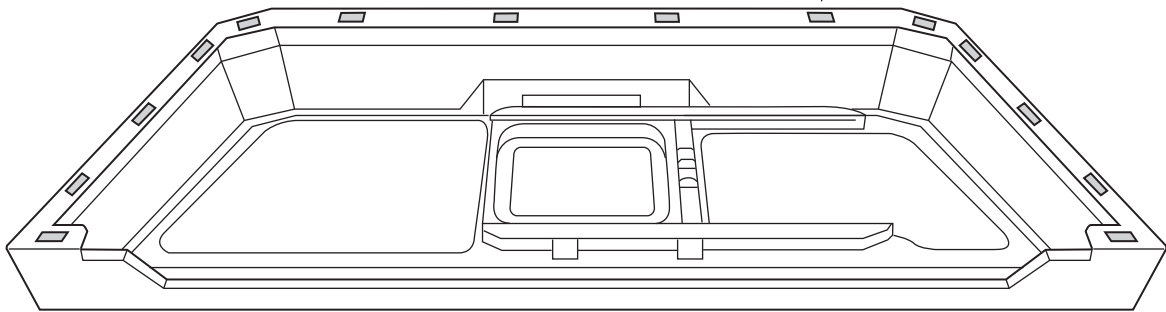
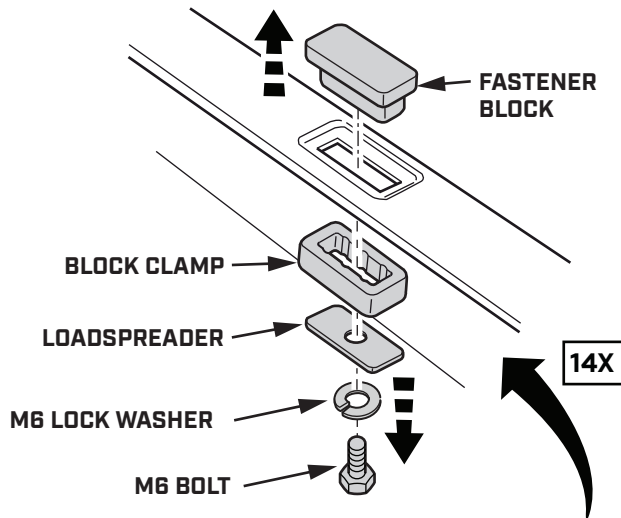
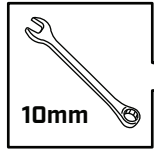

STEP 11

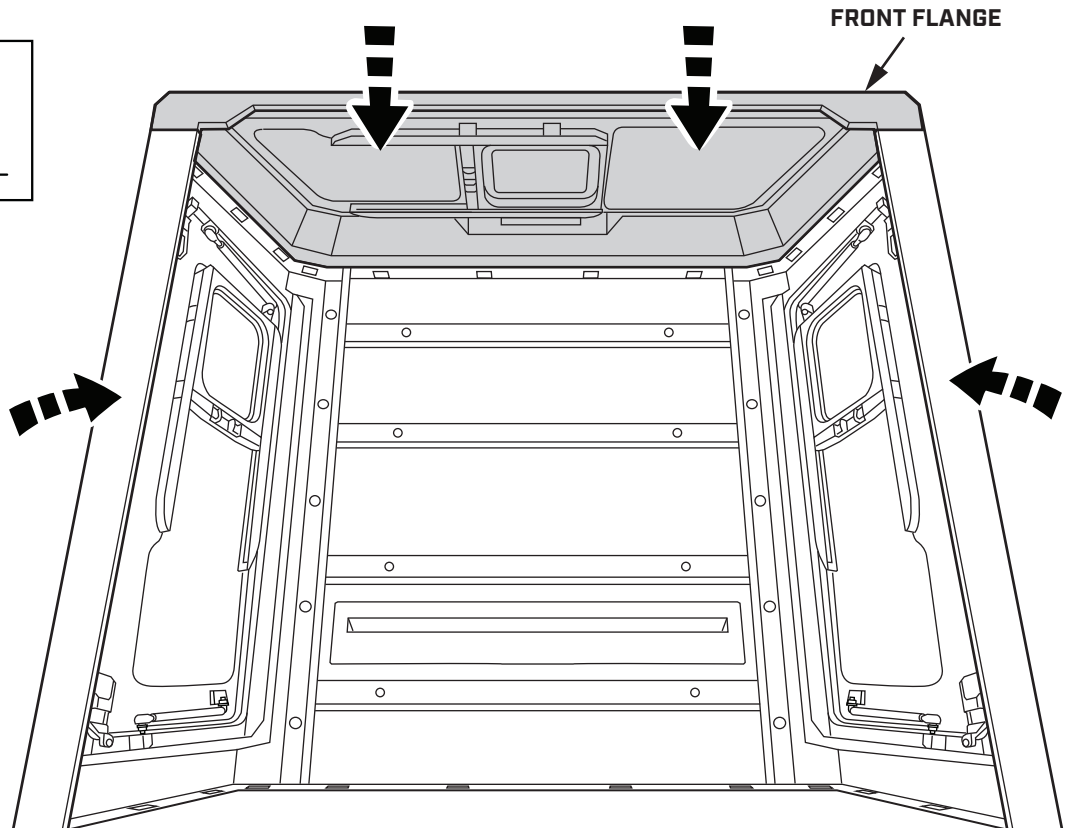
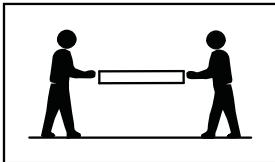

STEP 12

INSTALL HARDWARE
ALONG FRONT FLANGE
WITH BOLT ON INSIDE

HAND TIGHTEN IN THE
SEQUENCE SHOWN

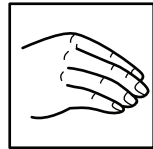

14X

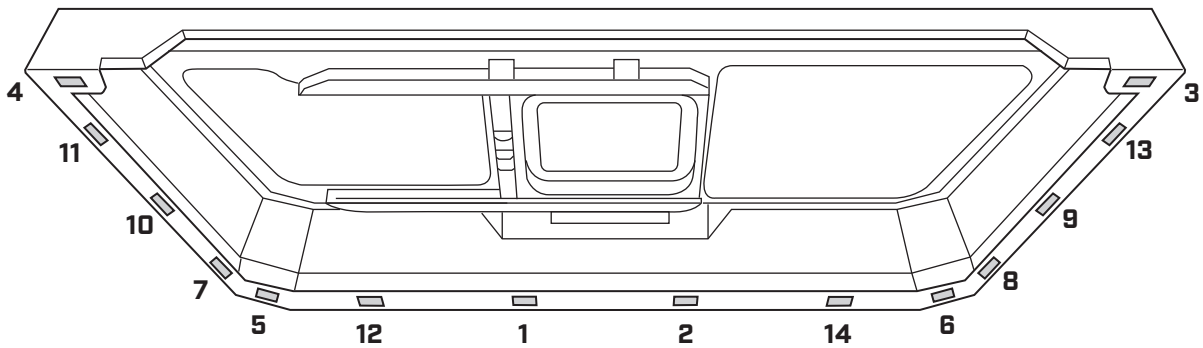
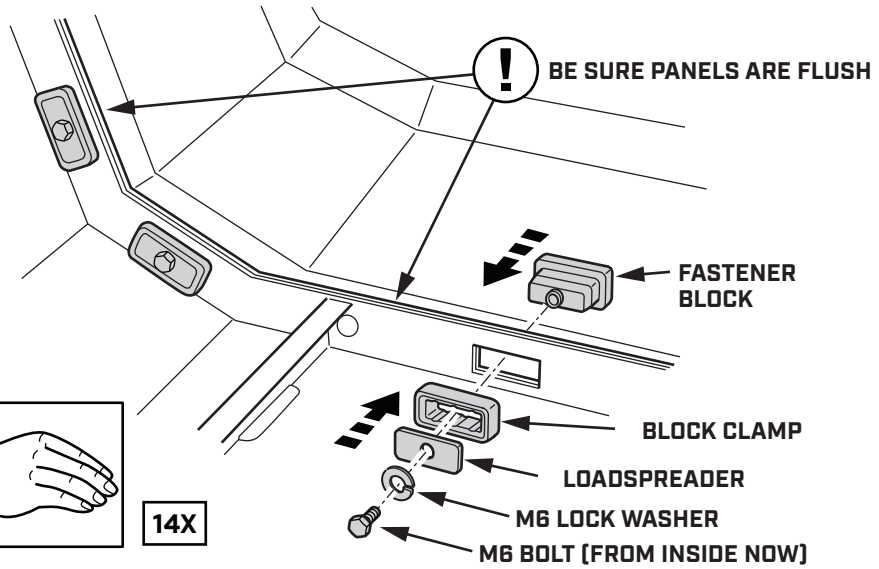

STEP 13

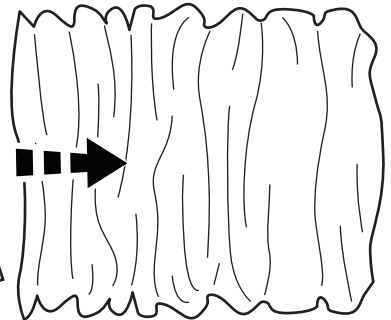
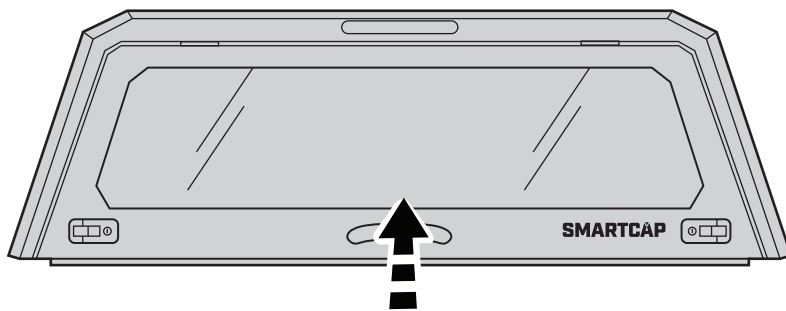
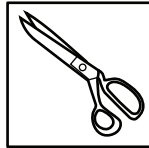
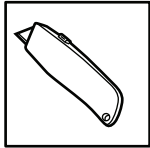

STEP 14

REMOVE ALL HARDWARE FROM REAR FLANGE

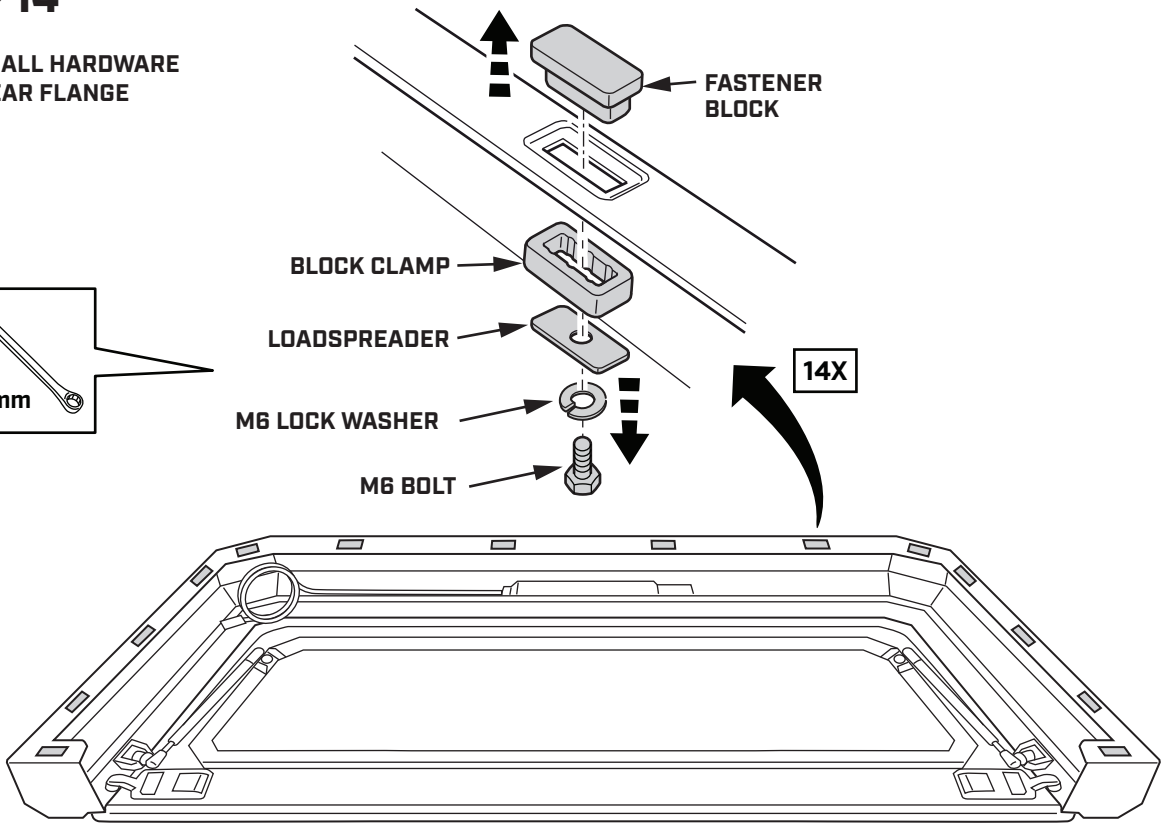
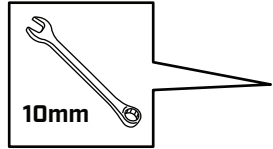

STEP 15

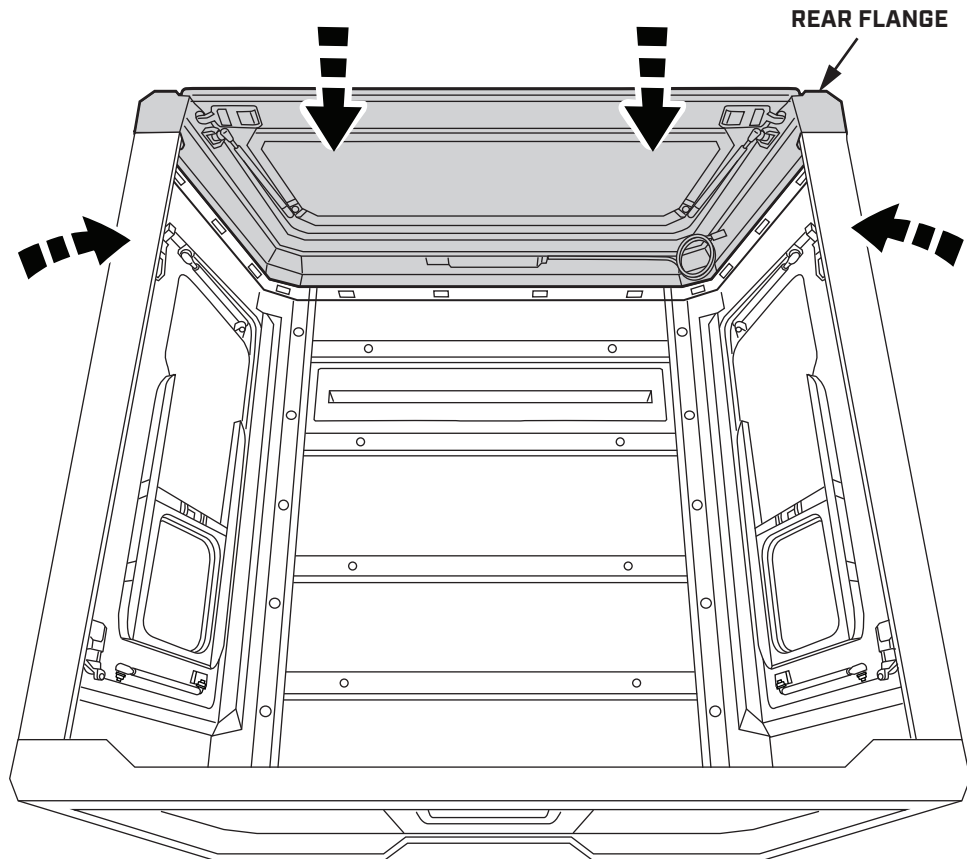
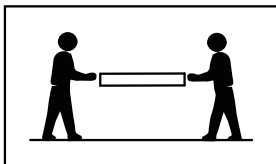

STEP 16

INSTALL HARDWARE
ALONG REAR FLANGE
WITH BOLT ON INSIDE

HAND TIGHTEN IN THE
SEQUENCE SHOWN

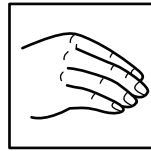

14X



BE SURE PANELS ARE FLUSH

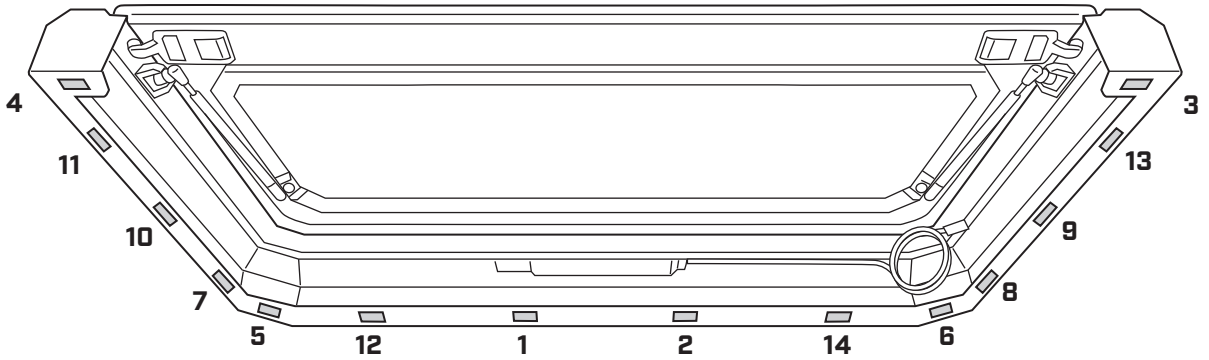
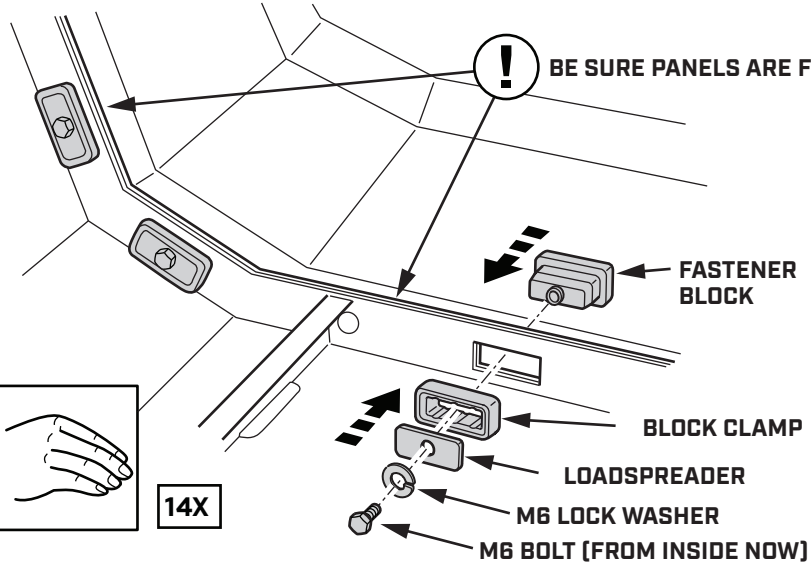

STEP 17

TIGHTEN ALL HARDWARE
WITH TORQUE WRENCH
AND 10mm SOCKET

14X

Min 6 N m
Max 12 N m
[4.4 lbs. ft.]

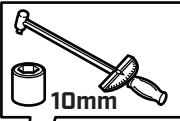

10mm

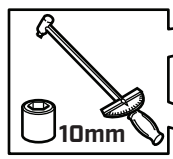

10mm

5X

Min 6 N m
Max 12 N m
[4.4 lbs. ft.]

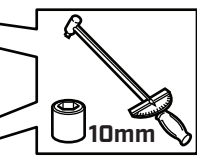

10mm

5X

Min 6 N m
Max 12 N m
[4.4 lbs. ft.]

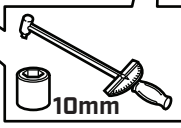
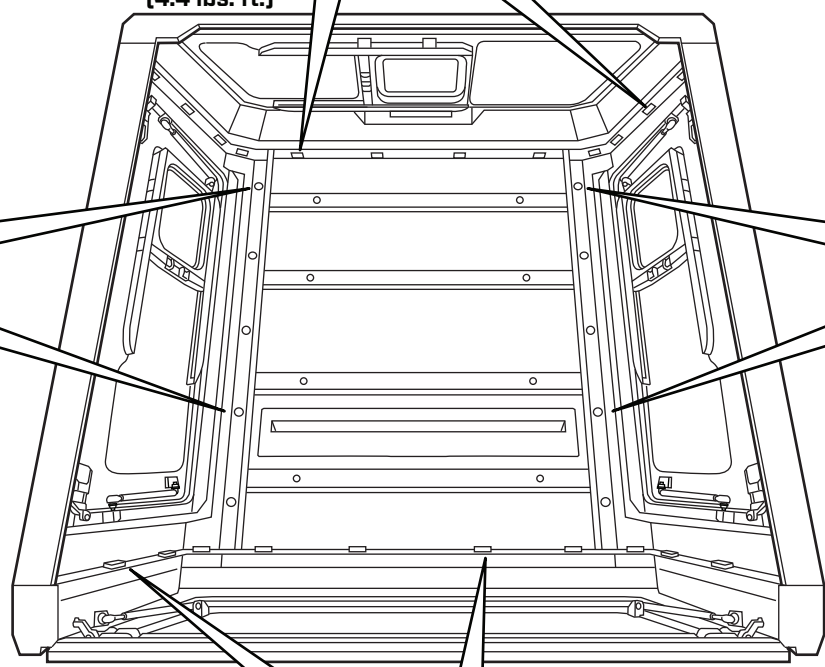

10mm

14X

Min 6 N m
Max 12 N m
[4.4 lbs. ft.]

STEP 18

APPLY D - RUBBER
TO BOTTOM OF SMARTCAP

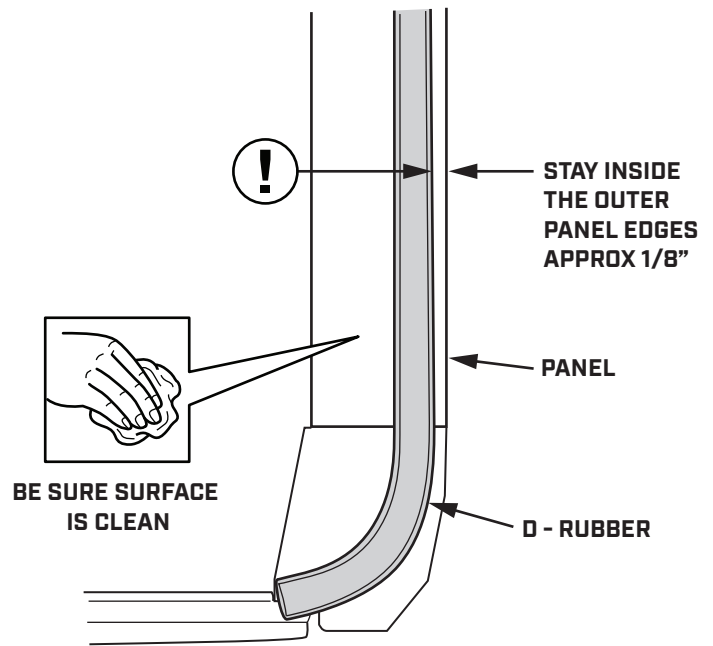
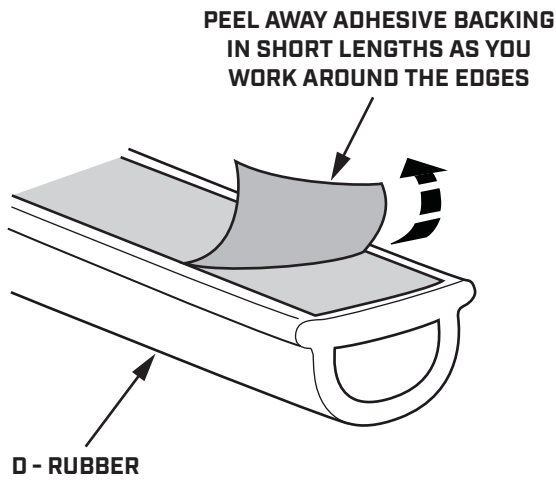

STEP 19

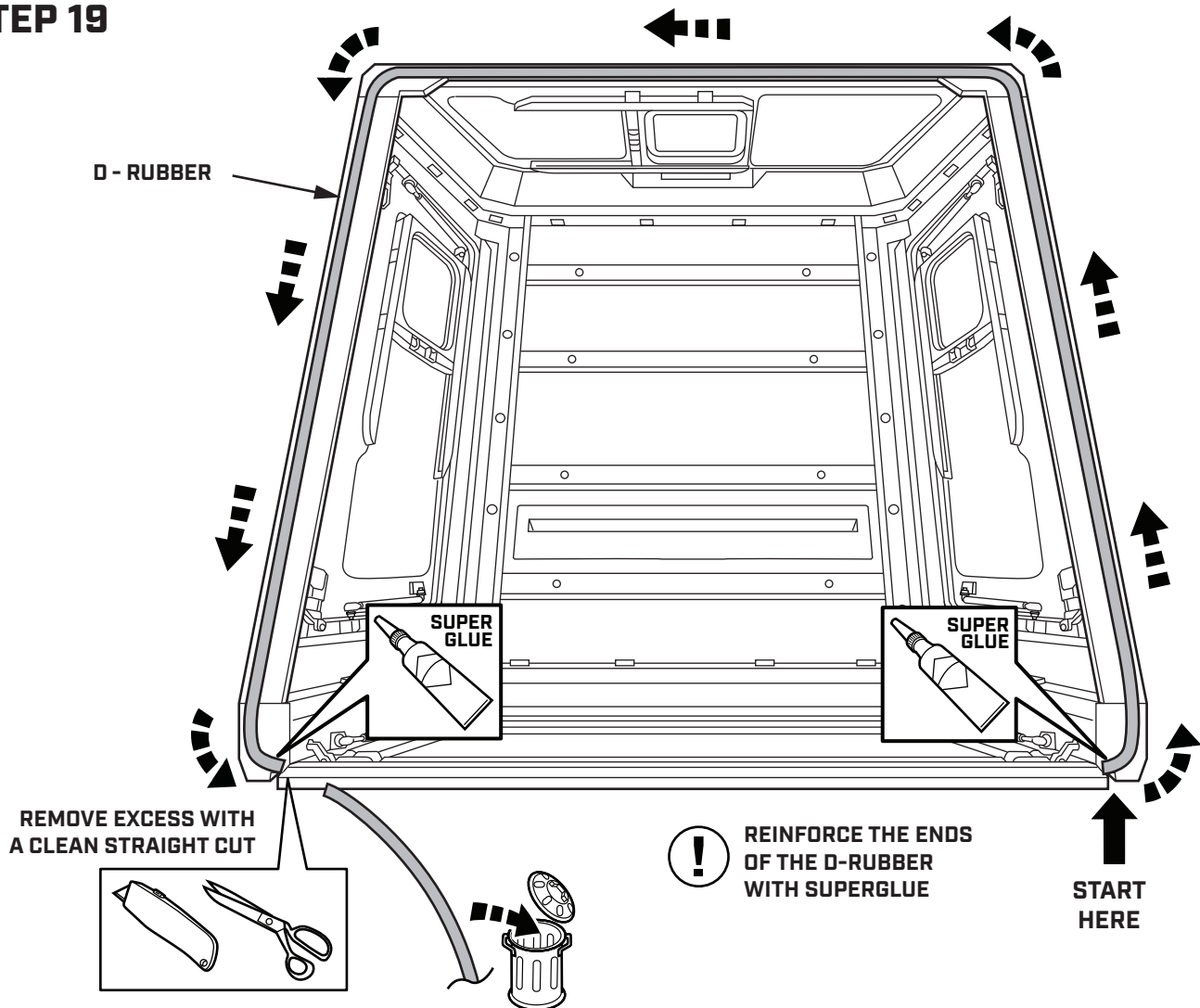

VEHICLE INSTALLATION

ASSEMBLY HARDWARE

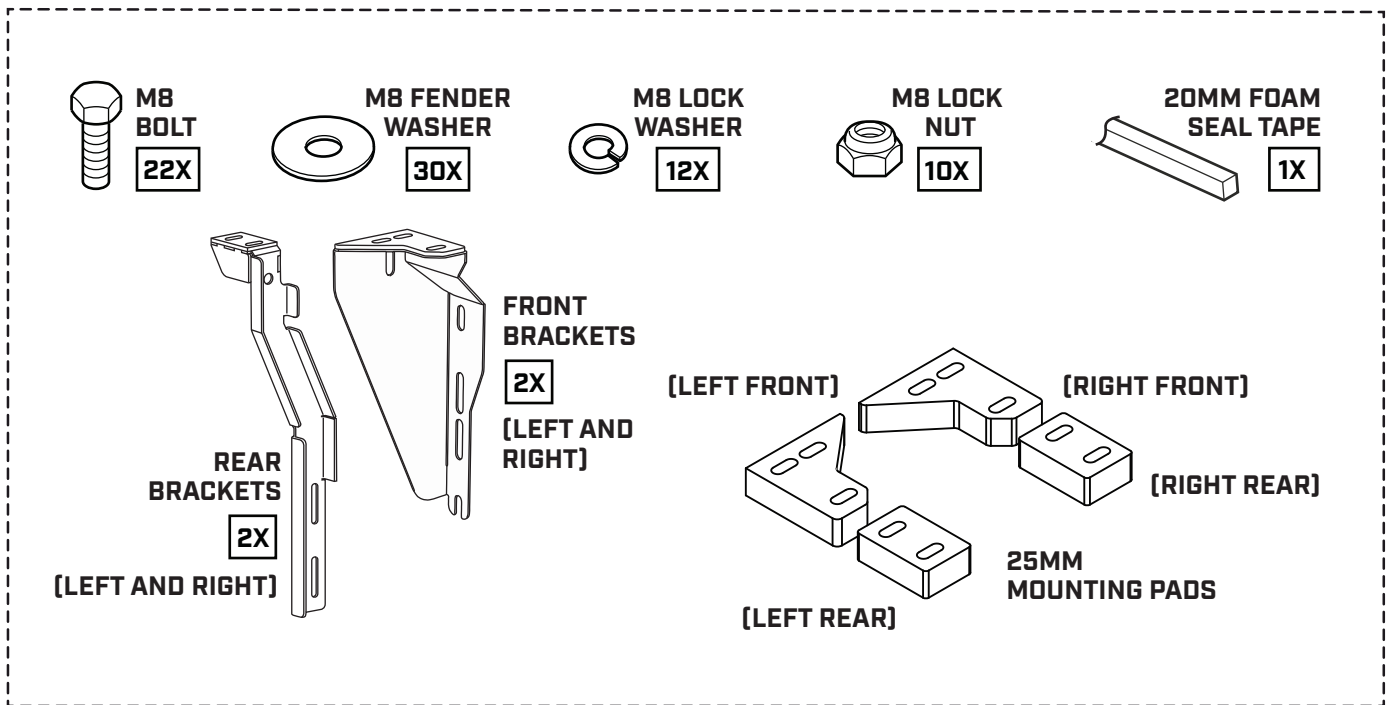

IMPORTANT

- ▼ ASSISTANTS WILL BE NEEDED FOR THIS INSTALLATION. FOUR PEOPLE ARE RECOMMENDED TO LIFT THE SMARTCAP ONTO THE VEHICLE.
- ▼ AVOID PINCHING OR CRUSHING HANDS AND FINGERS.

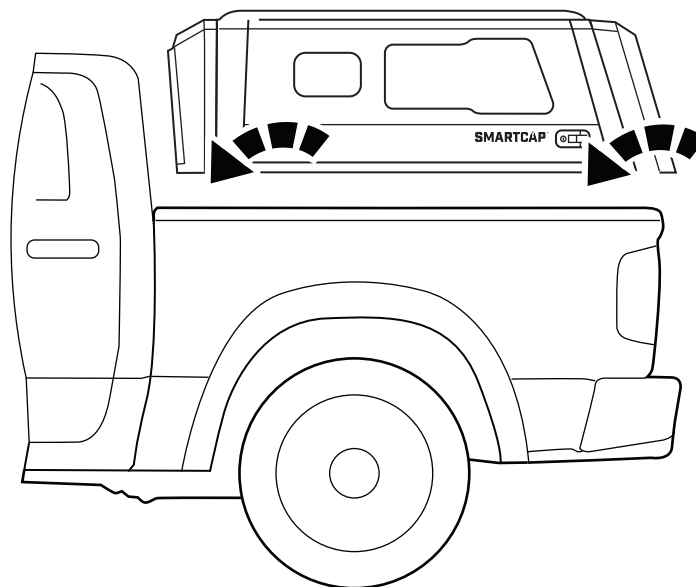

STEP 20

INSPECT THE TRUCK BED. IF FRONT EDGE IS LOWER THAN THE SIDES, ADD FOAM SEAL TAPE TO THE FRONT EDGE OF THE BED

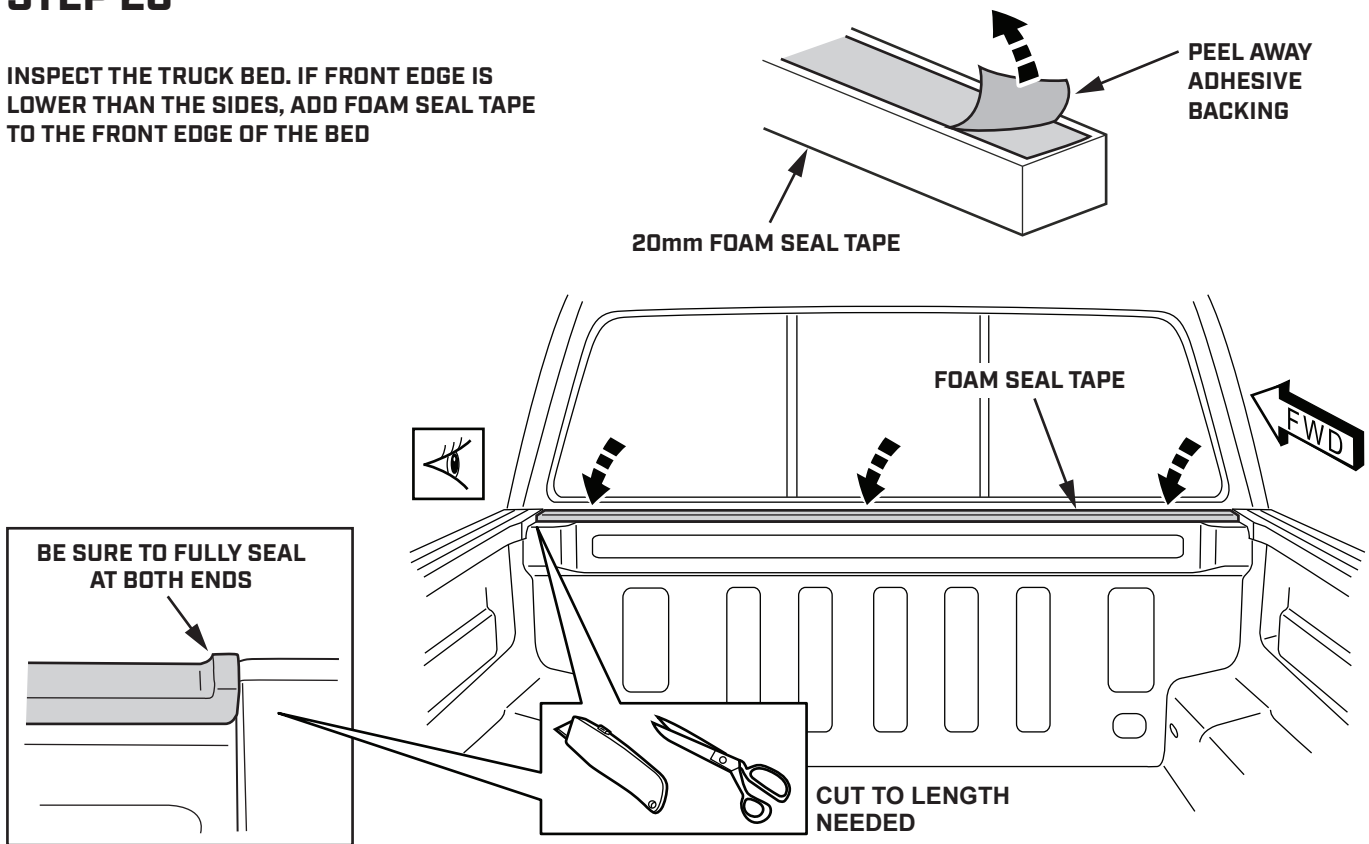

STEP 21

REMOVE THE FRONT TIE DOWN HOOK FROM THE INNER WALL OF THE TRUCK BED

POSITION THE RIGHT SIDE FRONT MOUNTING BRACKET IN THE FRONT CORNER OF THE TRUCK BED AS SHOWN

SECURE THE BRACKET WITH THE FASTENERS AS INDICATED, HAND TIGHTEN ONLY

REPEAT ON THE OPPOSITE SIDE OF THE VEHICLE WITH THE LEFT FRONT MOUNTING BRACKET

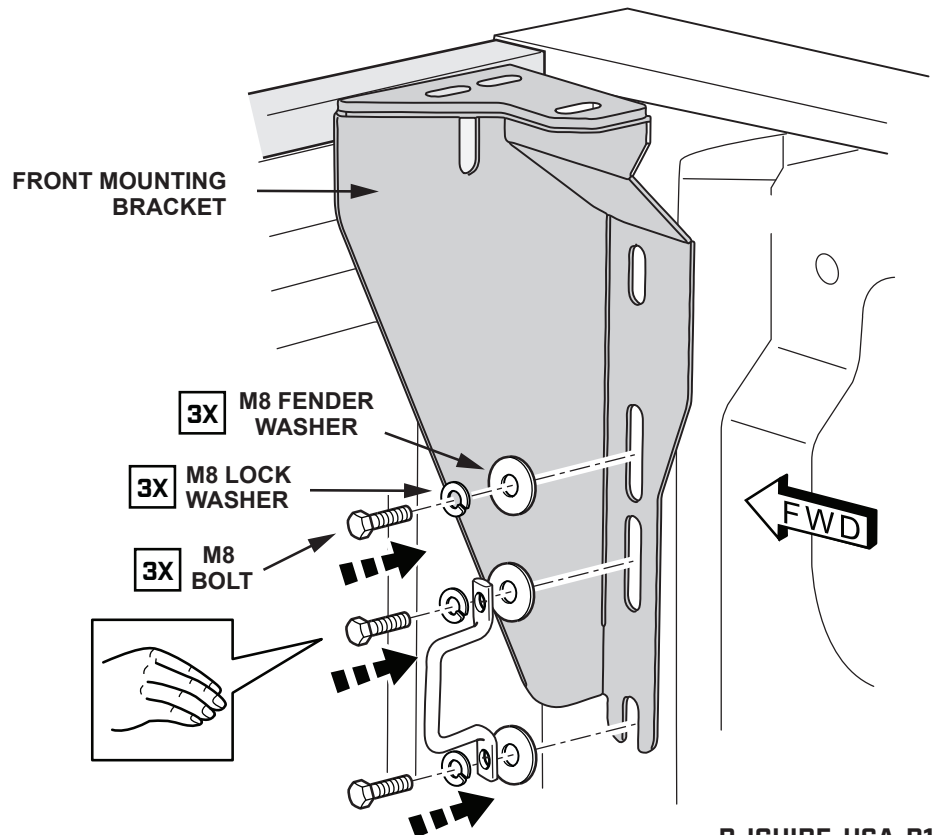

STEP 22

POSITION THE RIGHT SIDE FRONT MOUNTING PAD ON TOP OF THE MOUNTING BRACKET AS SHOWN

REPEAT ON THE OPPOSITE SIDE OF THE VEHICLE WITH THE LEFT FRONT MOUNTING BRACKET

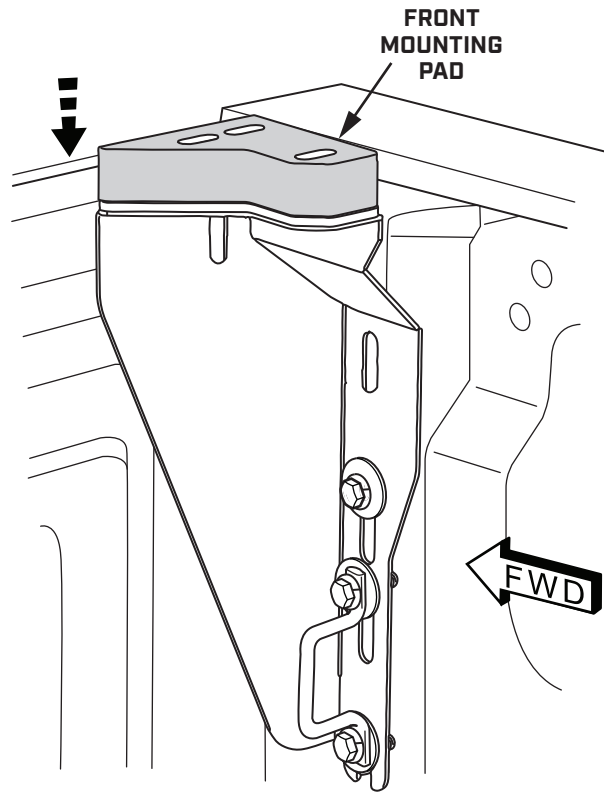

STEP 23

REMOVE THE REAR TIE DOWN HOOK FROM THE INNER WALL OF THE TRUCK BED

POSITION THE RIGHT SIDE REAR MOUNTING BRACKET IN THE BACK CORNER OF THE TRUCK BED AS SHOWN

SECURE THE BRACKET WITH THE FASTENERS AS INDICATED, HAND TIGHTEN ONLY

REPEAT ON THE OPPOSITE SIDE OF THE VEHICLE WITH THE LEFT REAR MOUNTING BRACKET

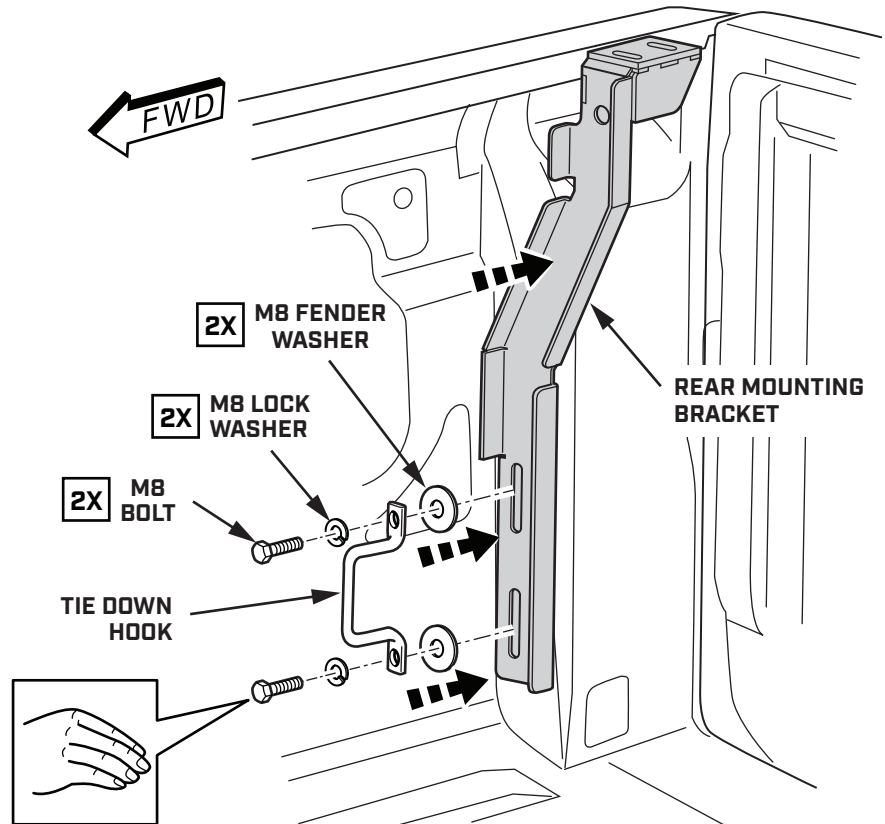

STEP 24

POSITION THE RIGHT SIDE REAR MOUNTING PAD ON TOP OF THE MOUNTING BRACKET AS SHOWN

REPEAT ON THE OPPOSITE SIDE OF THE VEHICLE WITH THE LEFT REAR MOUNTING BRACKET

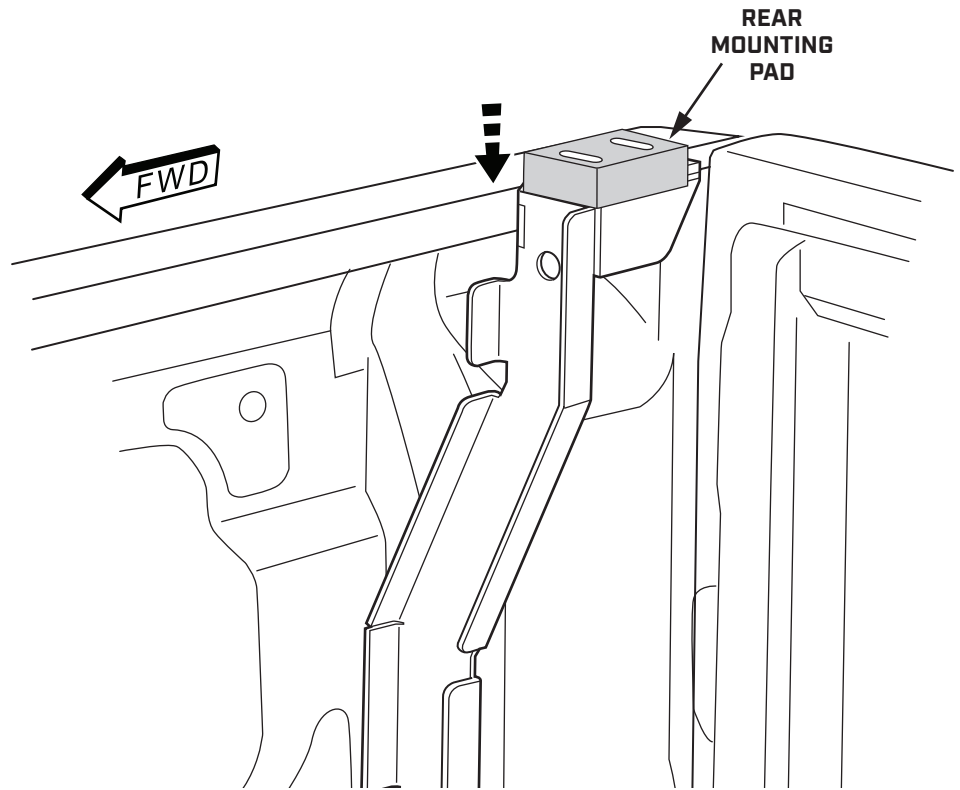

STEP 25

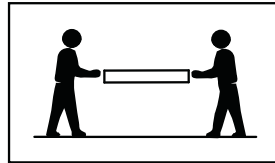
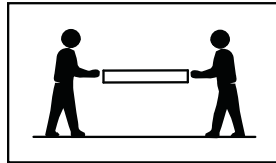

LIFT THE ASSEMBLED SMARTCAP ONTO THE TRUCK BED



BE SURE TO NOT SCRAPER OR DAMAGE THE D-RUBBER

CHECK THAT THE SMARTCAP IS PROPERLY POSITIONED AND CENTERED ON THE TRUCK BED

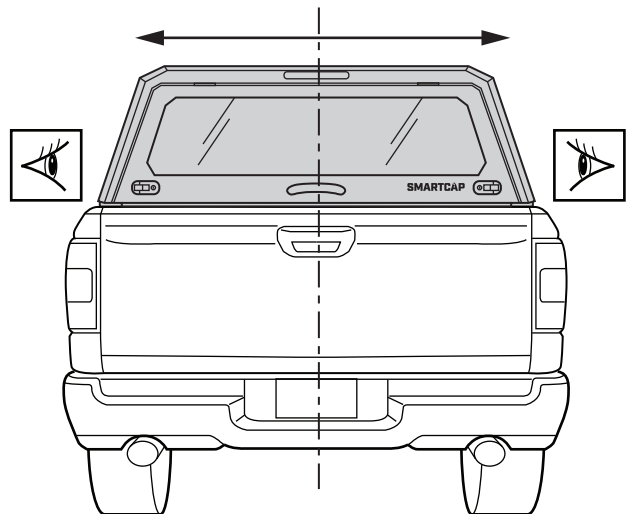
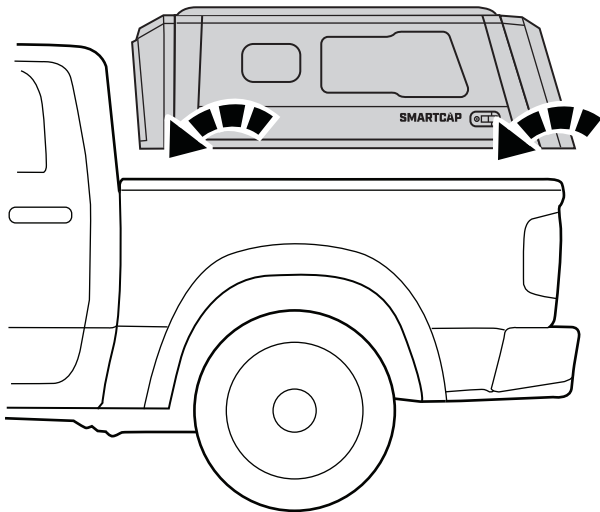

STEP 26

SECURE THE SMARTCAP TO THE RIGHT FRONT MOUNTING BRACKET WITH THE FASTENERS AS INDICATED, HAND TIGHTEN ONLY

REPEAT ON THE OPPOSITE SIDE OF THE VEHICLE WITH THE LEFT FRONT MOUNTING BRACKET

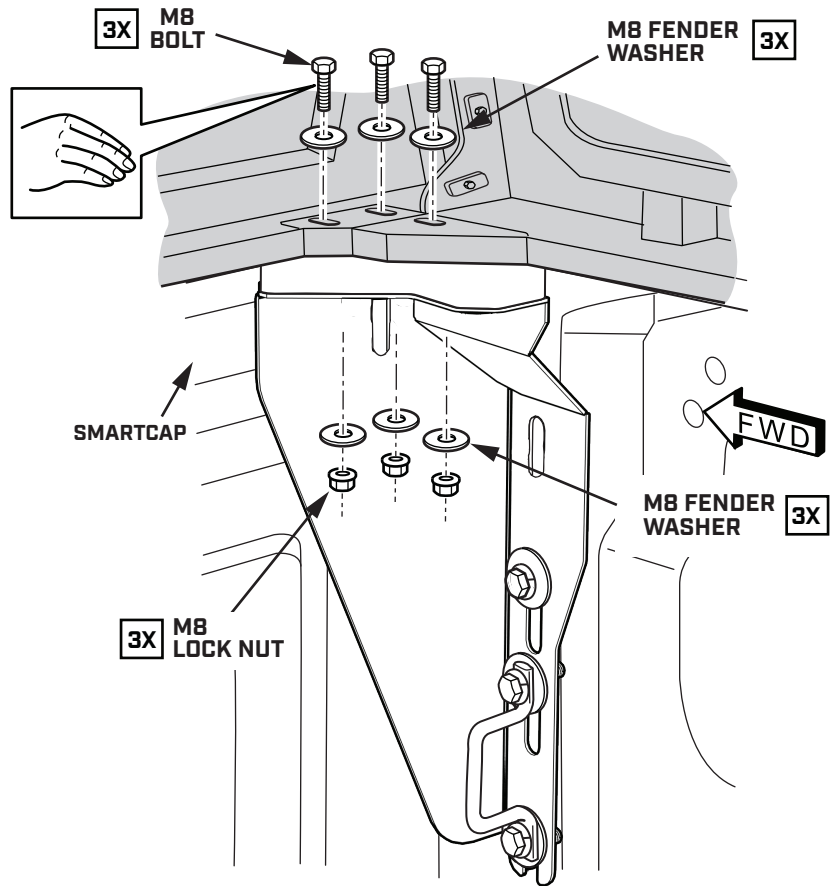

STEP 27

SECURE THE SMARTCAP TO THE RIGHT REAR MOUNTING BRACKET WITH THE FASTENERS AS INDICATED, HAND TIGHTEN ONLY

REPEAT ON THE OPPOSITE SIDE OF THE VEHICLE WITH THE LEFT REAR MOUNTING BRACKET

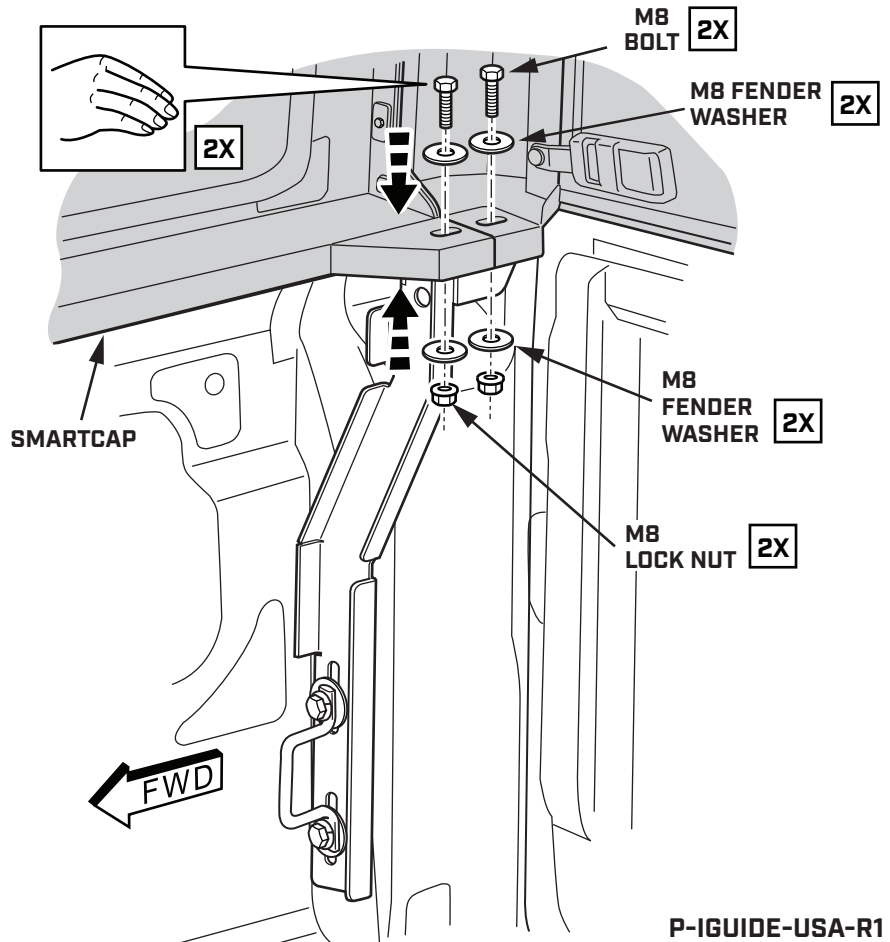

STEP 28

ONCE ALL THE FASTENERS ARE INSTALLED, PARTIALLY TIGHTEN WITH SOCKET WRENCH AS INDICATED

PARTIALLY TIGHTEN FASTENERS ON ALL FOUR CORNERS OF THE VEHICLE

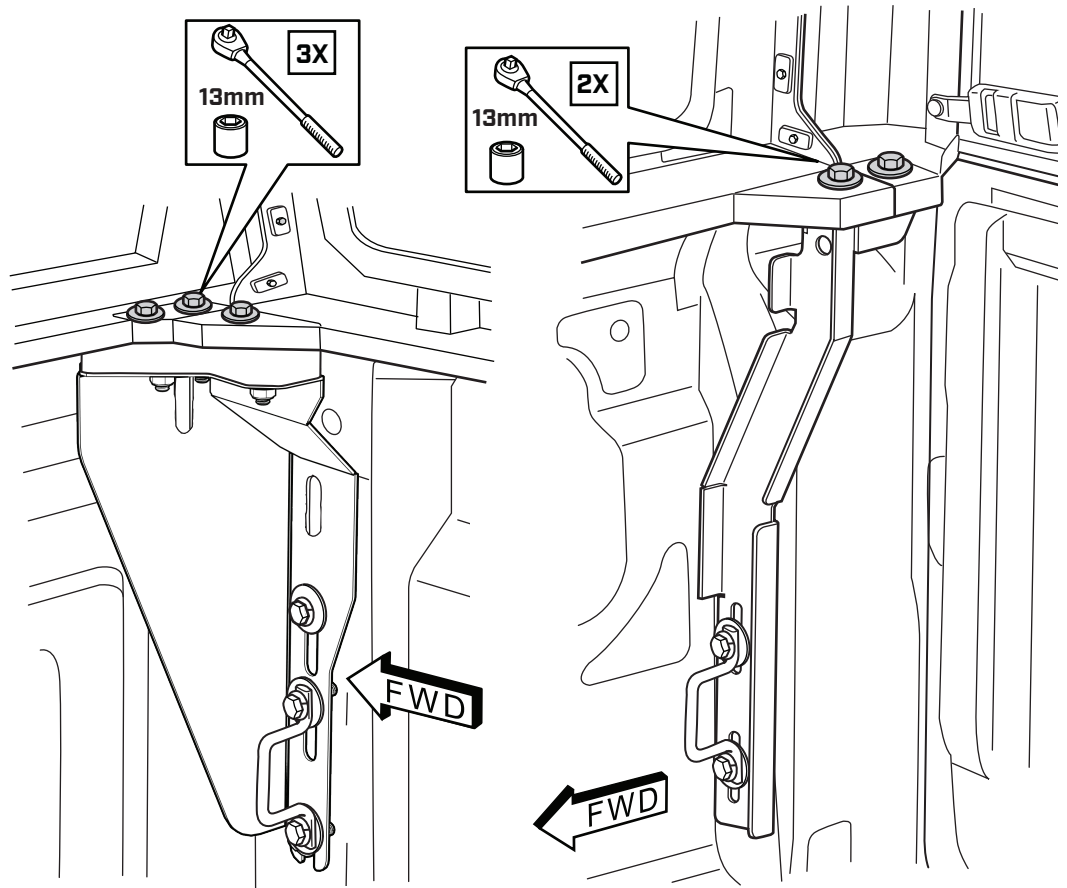

STEP 29

PRESS DOWN ON THE SMARTCAP TO ACHIEVE 2MM - 3MM COMPRESSION ON THE D-RUBBER AND CONTINUE TIGHTENING BRACKET FASTENERS WITH SOCKET WRENCH AS INDICATED

CONTINUE TIGHTENING FASTENERS ON ALL FOUR CORNERS OF THE VEHICLE

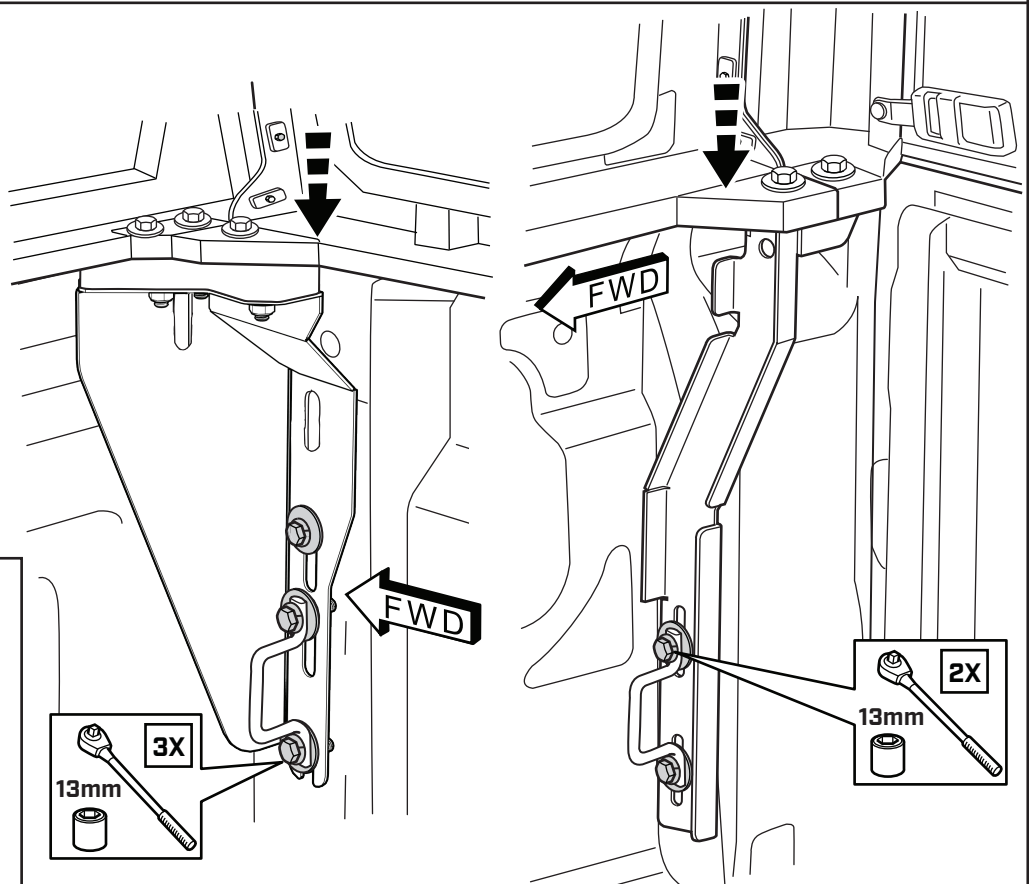
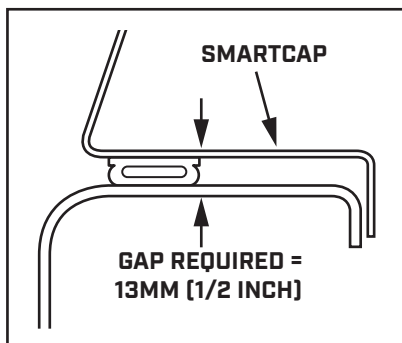

STEP 30

ONCE SMARTCAP IS POSITIONED CORRECTLY, FULLY TIGHTEN UPPER FASTENERS WITH TORQUE WRENCH AS INDICATED

FULLY TIGHTEN UPPER FASTENERS ON ALL FOUR CORNERS OF THE VEHICLE

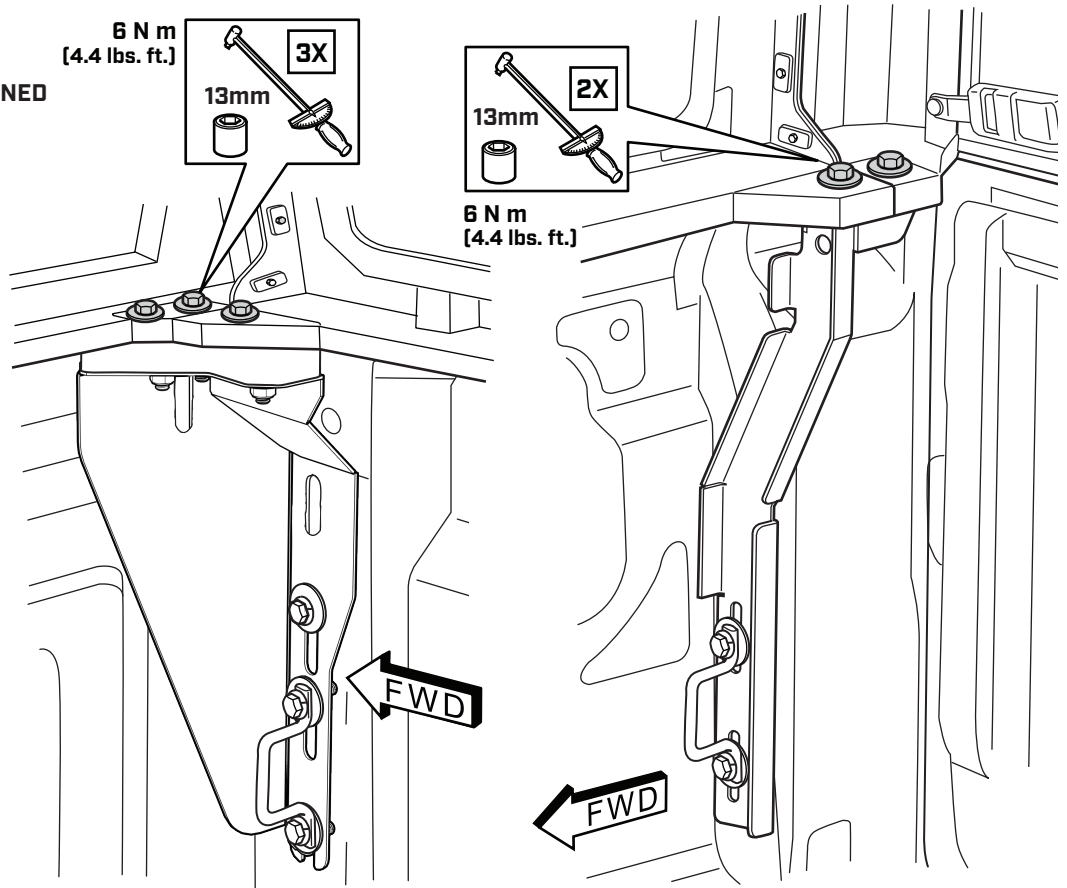

STEP 31

ONCE SMARTCAP IS POSITIONED CORRECTLY, FULLY TIGHTEN LOWER FASTENERS WITH TORQUE WRENCH AS INDICATED

FULLY TIGHTEN LOWER FASTENERS ON ALL FOUR CORNERS OF THE VEHICLE

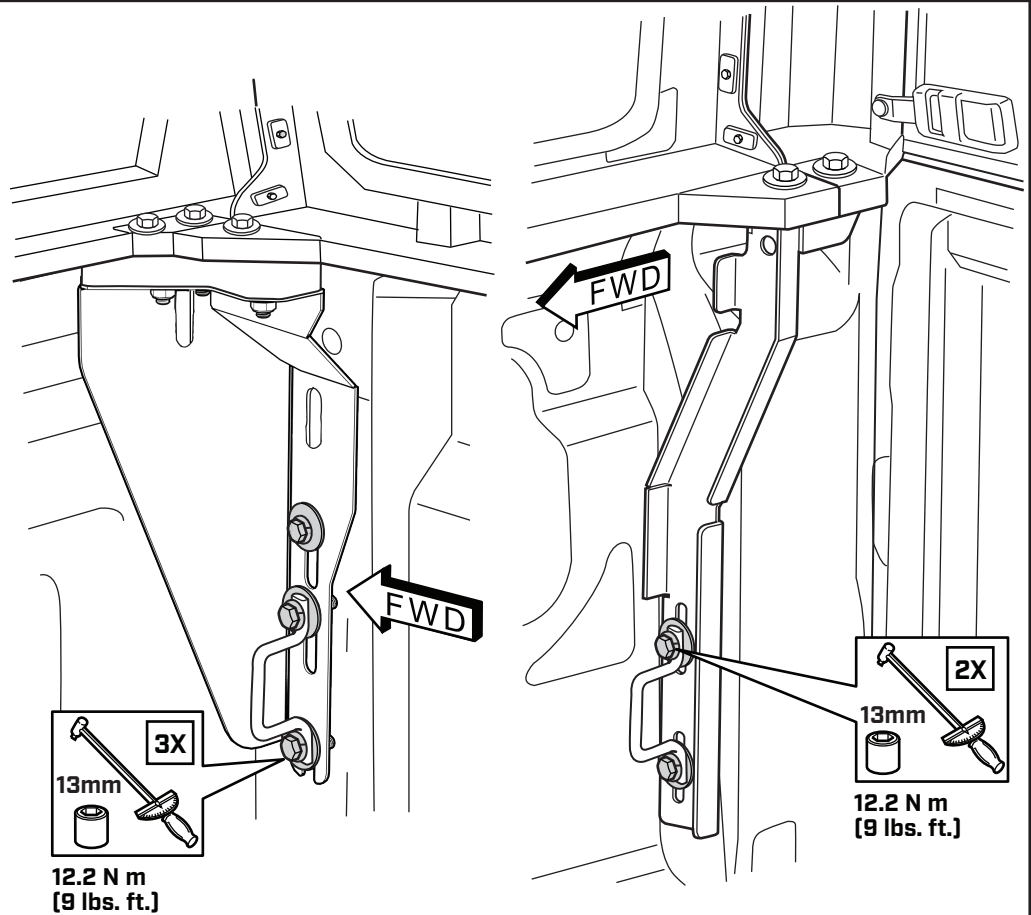

THIRD BRAKE LIGHT CONNECTOR INSTALLATION



IMPORTANT

- ▼ BE SURE THE VEHICLE IS TURNED OFF FOR THIS INSTALLATION.
- ▼ READ THROUGH THE ENTIRE PROCEDURE BEFORE STARTING AND FOLLOW THE STEPS CAREFULLY TO ENSURE THE THIRD BRAKE LIGHT AND TRAILER PLUG WILL FUNCTION PROPERLY.
- ▼ USE A TEST LIGHT TO CHECK FOR SUCCESSFUL INSTALLATION.

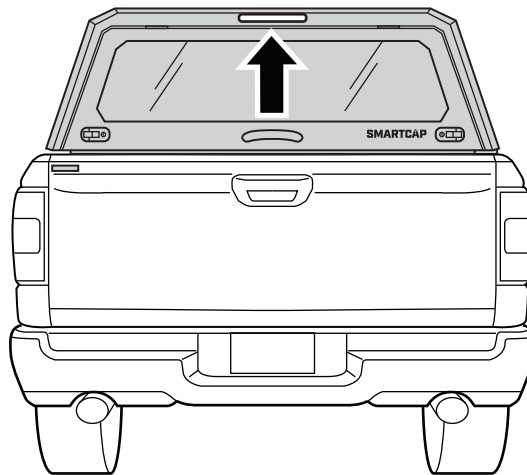

LED TAIL LIGHT HARNESS

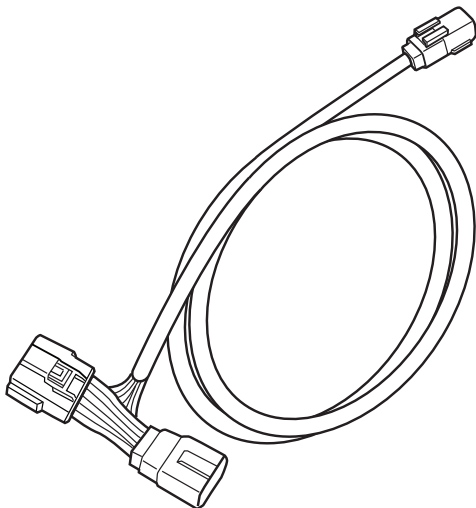

INCLUDED IN FITMENT KIT

INCANDESCENT TAIL LIGHT HARNESS

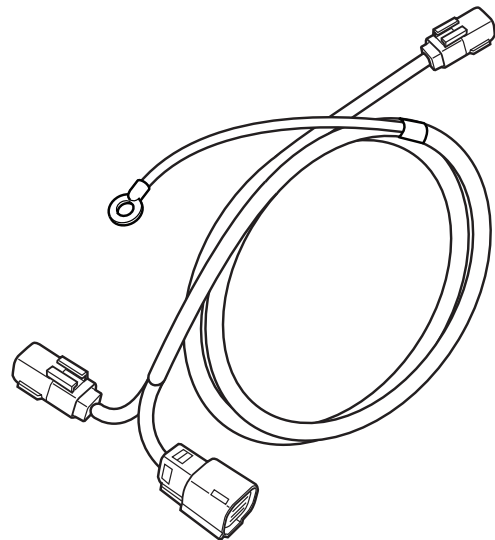

IF YOUR RANGER IS EQUIPPED WITH INCANDESCENT TAILLIGHTS, TO RECEIVE THE APPROPRIATE HARNESS, CONTACT SUPPORT.NA@SMARTCAP.COM

STEP 32

UNTIE THE THIRD BRAKE LIGHT EXTENSION HARNESS FROM WHERE IT IS ATTACHED TO THE SMARTCAP AT THE RIGHT REAR CORNER

NOTE: THE CONNECTOR ON THE END OF THE HARNESS WILL NEED TO BE DE-PINNED IN ORDER TO ROUTE THROUGH THIS HOLE

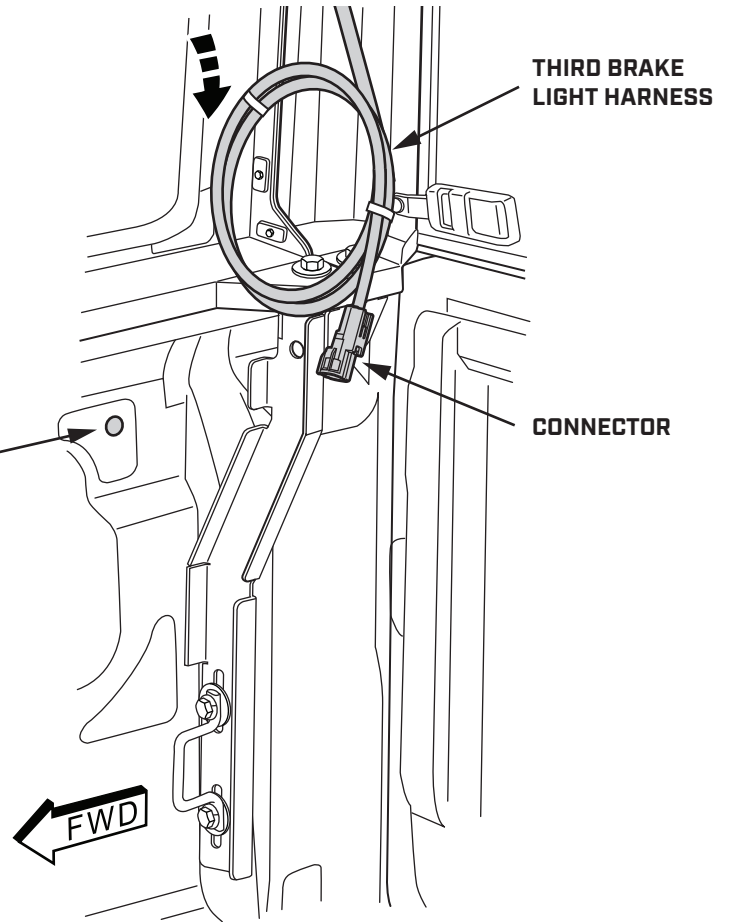

STEP 33

DE-PIN CONNECTOR

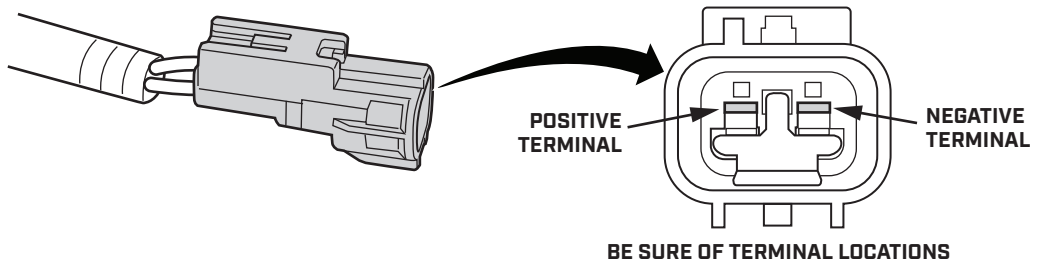

A. USE A SCREWDRIVER TO PULL THE LOCK CLIP FORWARD

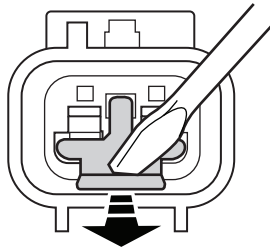

B. USE A PIN TOOL TO PRESS DOWN ON THE WIRE RELEASE TABS

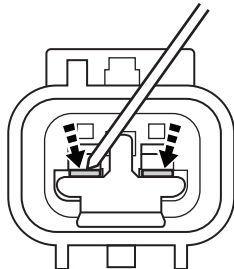

C. WHILE PRESSING DOWN ON THE RELEASE TABS, REMOVE EACH OF THE WIRES FROM THE CONNECTOR

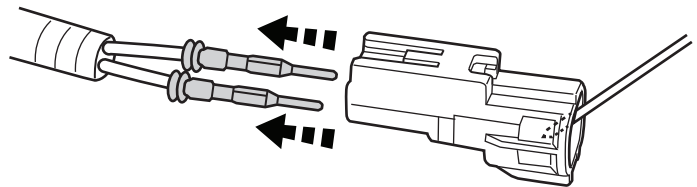

D. REVERSE THE PROCESS TO REINSTALL THE CONNECTOR

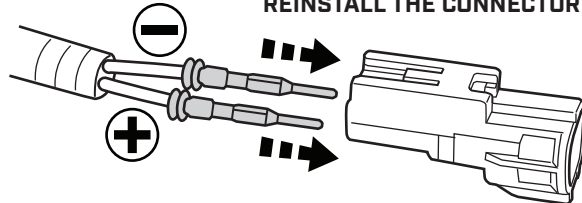

STEP 34

ROUTE THE THIRD BRAKE LIGHT EXTENSION HARNESS THROUGH THE HOLE AND DOWN TOWARDS THE INSIDE REAR BUMPER

NOTE: BE SURE NOT TO DAMAGE THE WIRE TERMINALS AT THE END OF THE HARNESS

THIRD BRAKE LIGHT HARNESS

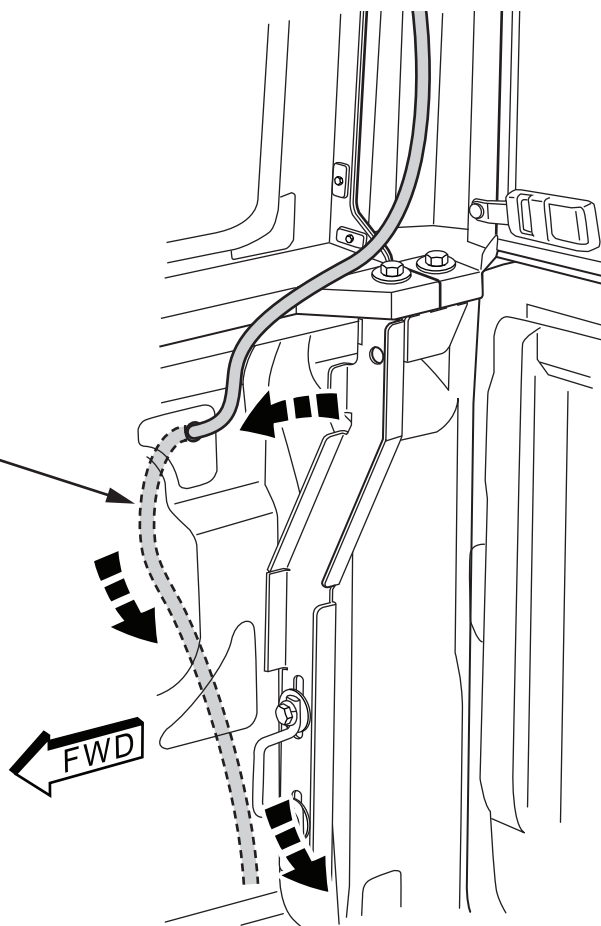

STEP 35

RE-ATTACH THE CONNECTOR TO THE THIRD BRAKE LIGHT HARNESS IN THE SAME FASHION AS IT WAS REMOVED

SEE STEP 2

THIRD BRAKE LIGHT HARNESS

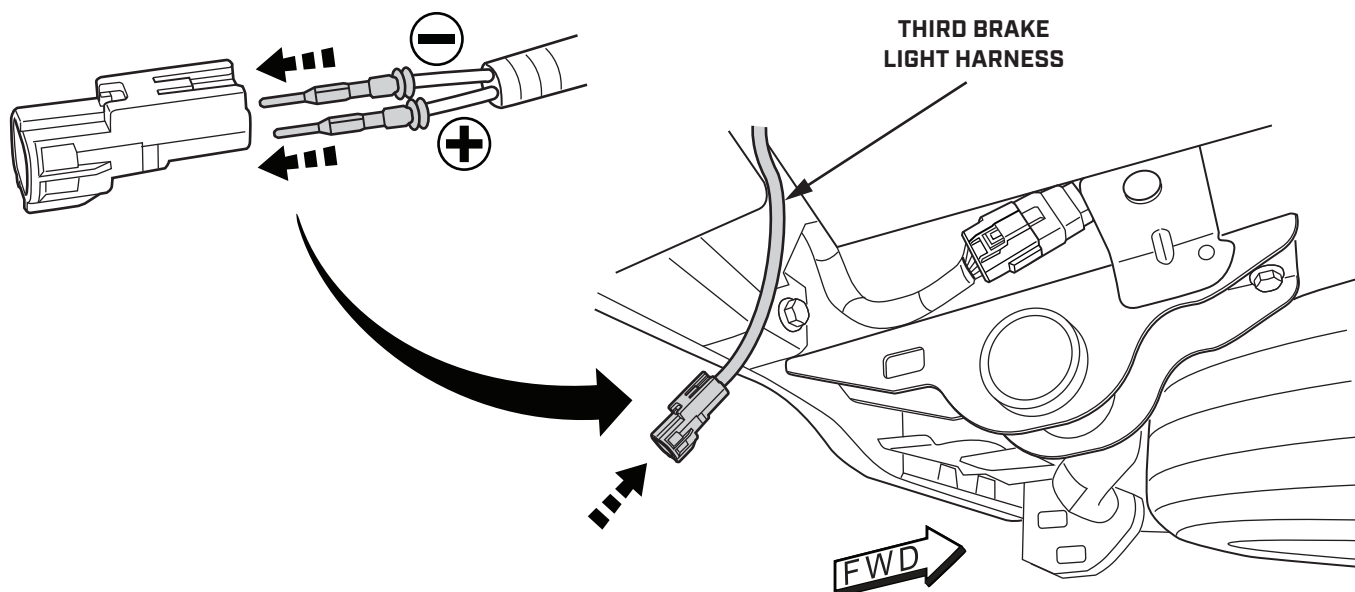

STEP 36

LED TAIL LIGHTS

CONNECT THE LED T-HARNESS TO THE 2-PIN CONNECTOR AT THE END OF THE BRAKE LIGHT EXTENSION HARNESS

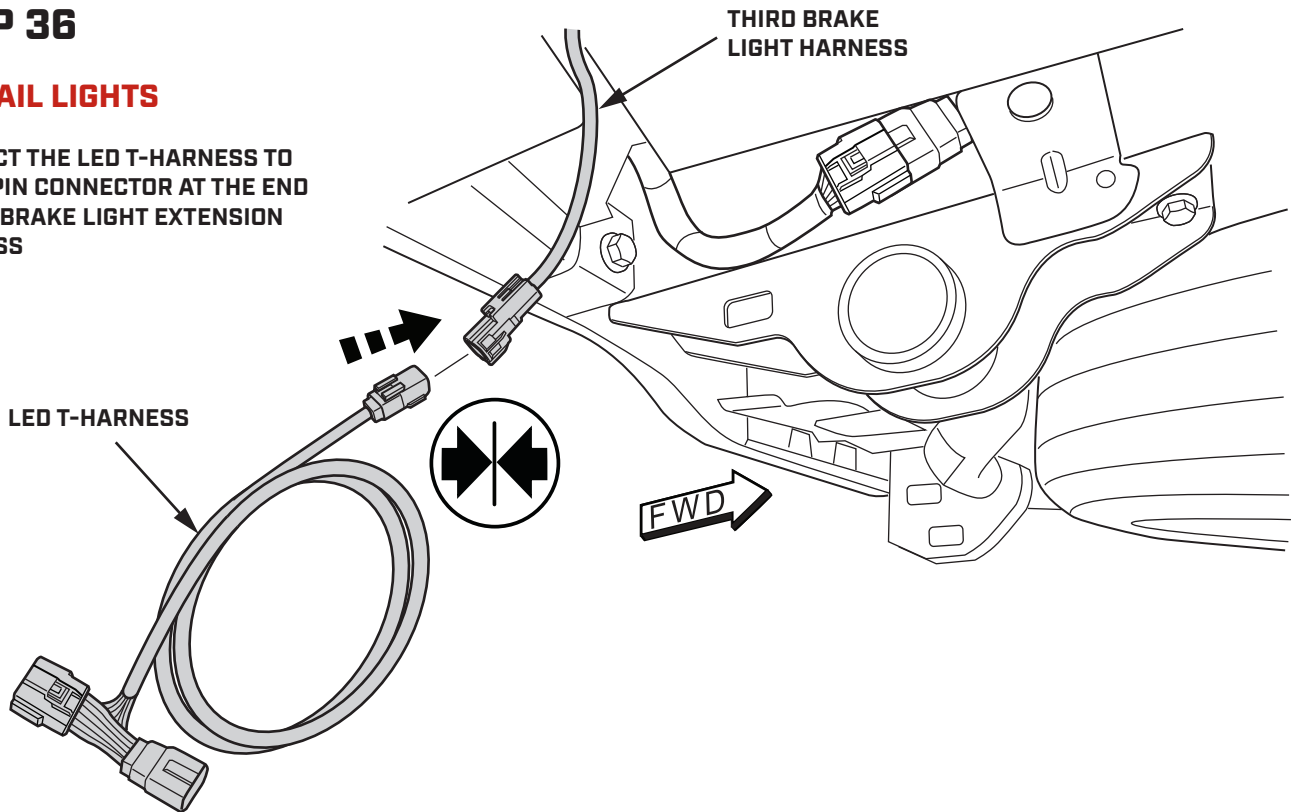

STEP 37

LOCATE THE 16-PIN CONNECTOR ON THE SIDE OF THE PASSENGER CHASSIS RAIL AND DISCONNECT IT

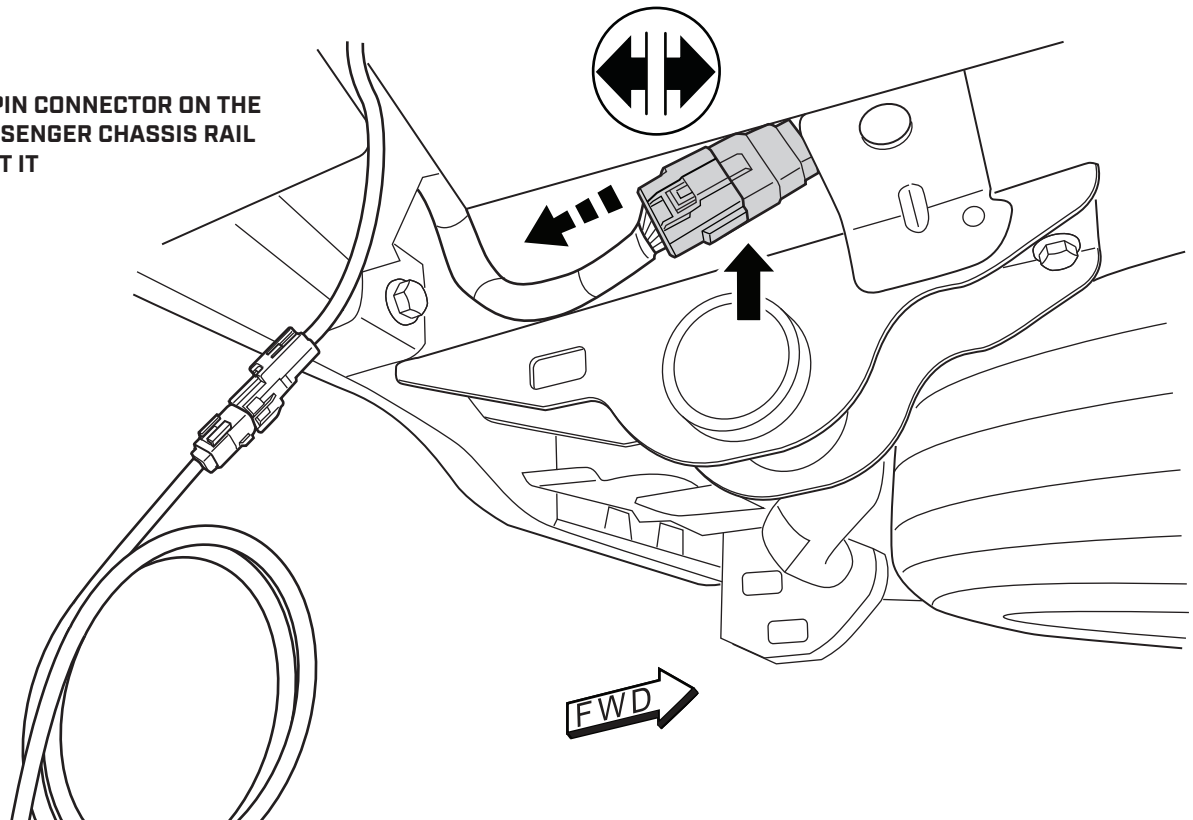

STEP 38

CONNECT THE T-HARNESS FEMALE CONNECTOR TO THE VEHICLE HARNESS MALE CONNECTOR

CONNECT THE T-HARNESS MALE CONNECTOR TO THE VEHICLE HARNESS FEMALE CONNECTOR

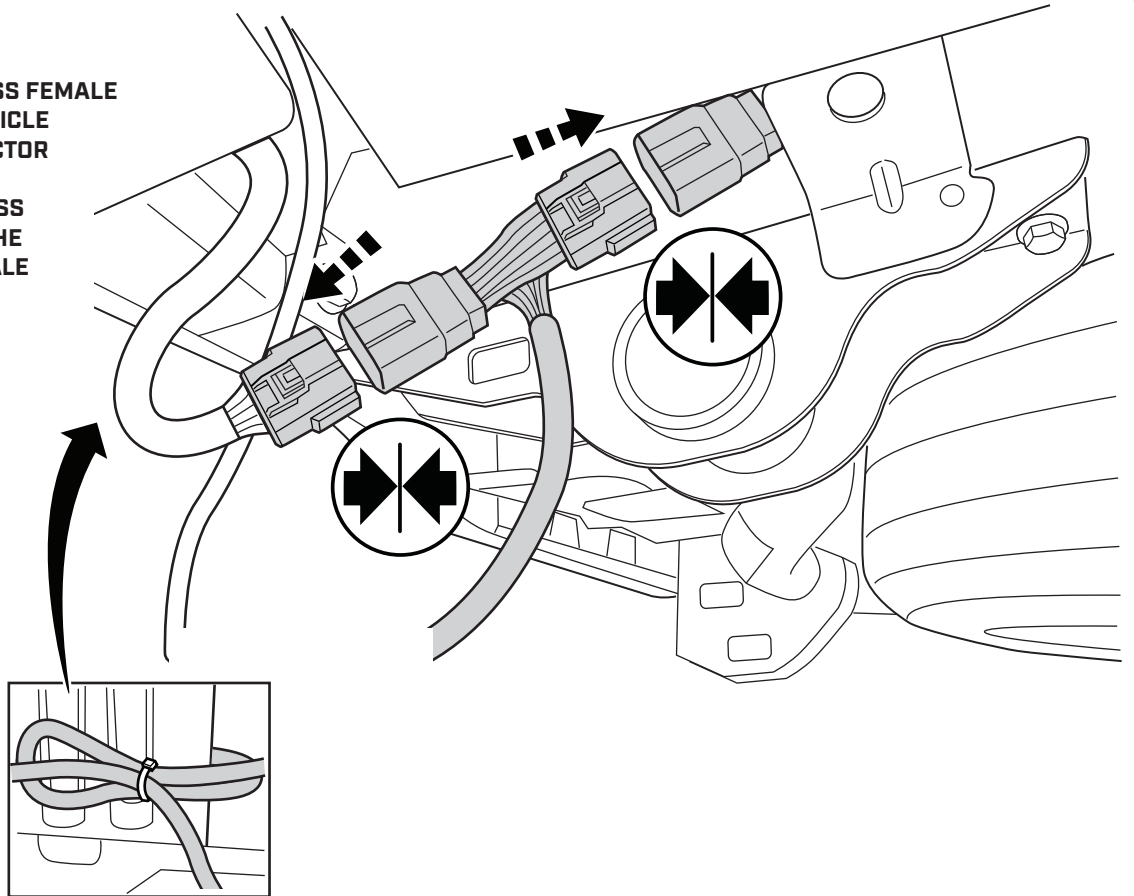

STEP 39

INCANDESCENT TAIL LIGHTS

CONNECT THE INCANDESCENT T-HARNESS TO THE 2-PIN CONNECTOR AT THE END OF THE BRAKE LIGHT EXTENSION HARNESS

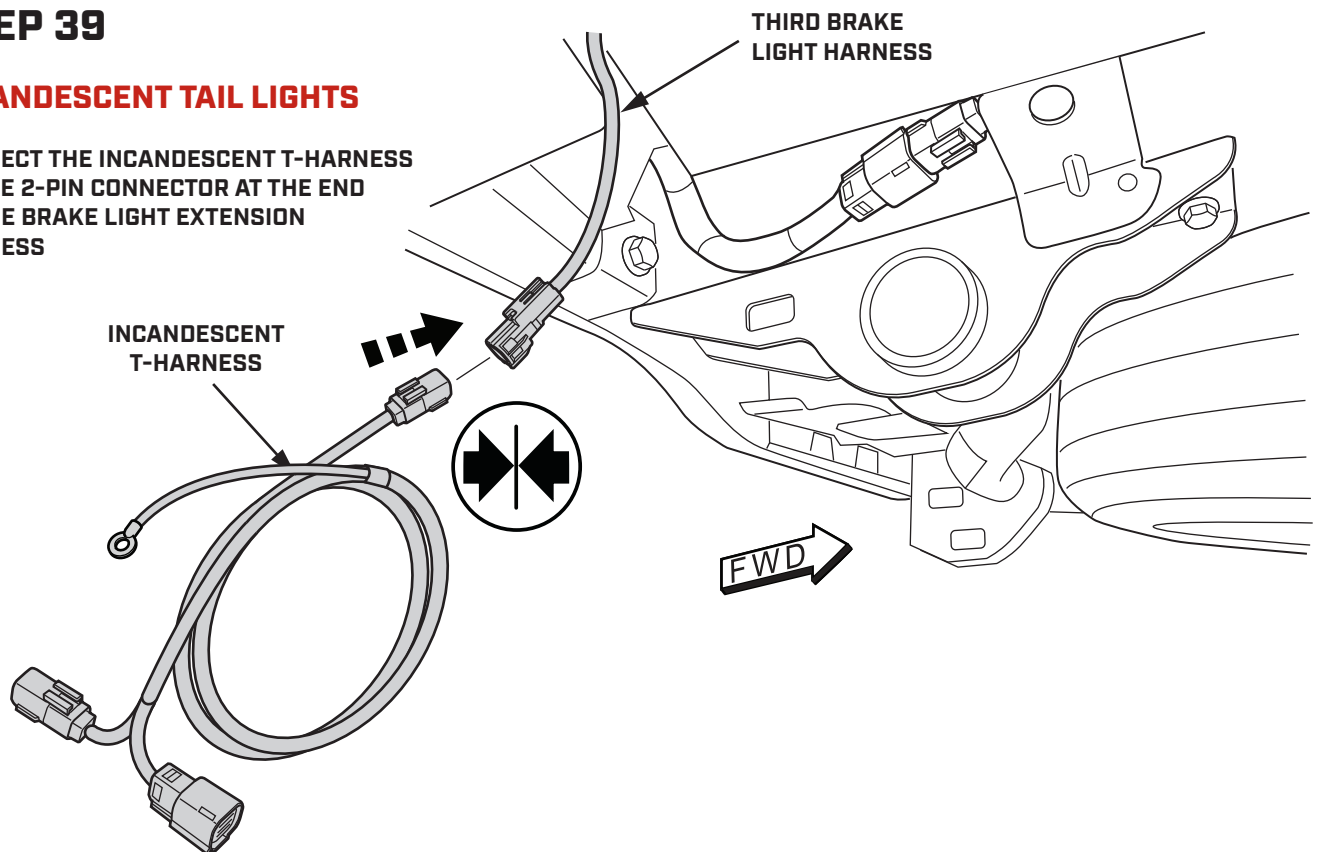

STEP 40

LOCATE THE 6-PIN CONNECTOR ON THE SIDE OF THE PASSENGER CHASSIS RAIL AND DISCONNECT IT

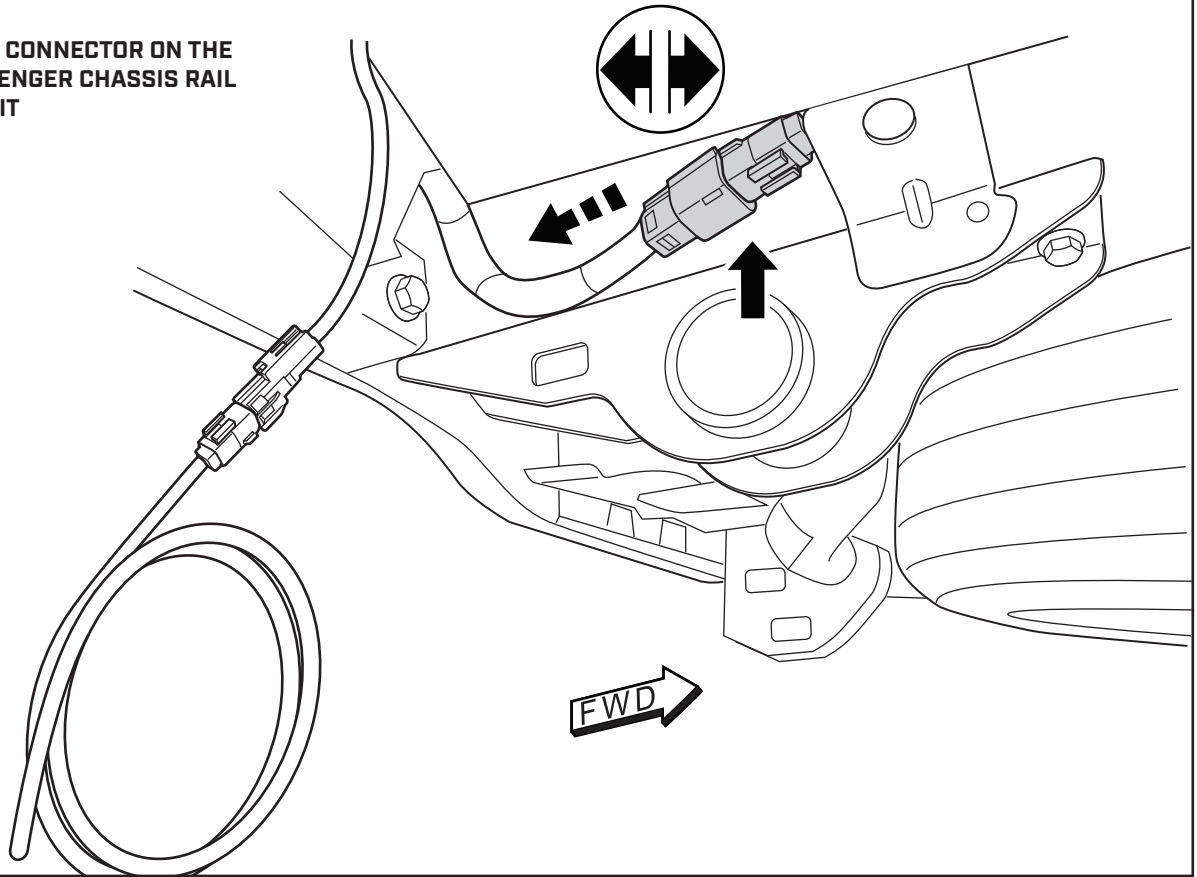

STEP 41

CONNECT THE T-HARNESS FEMALE CONNECTOR TO THE VEHICLE HARNESS MALE CONNECTOR

CONNECT THE T-HARNESS MALE CONNECTOR TO THE VEHICLE HARNESS FEMALE CONNECTOR

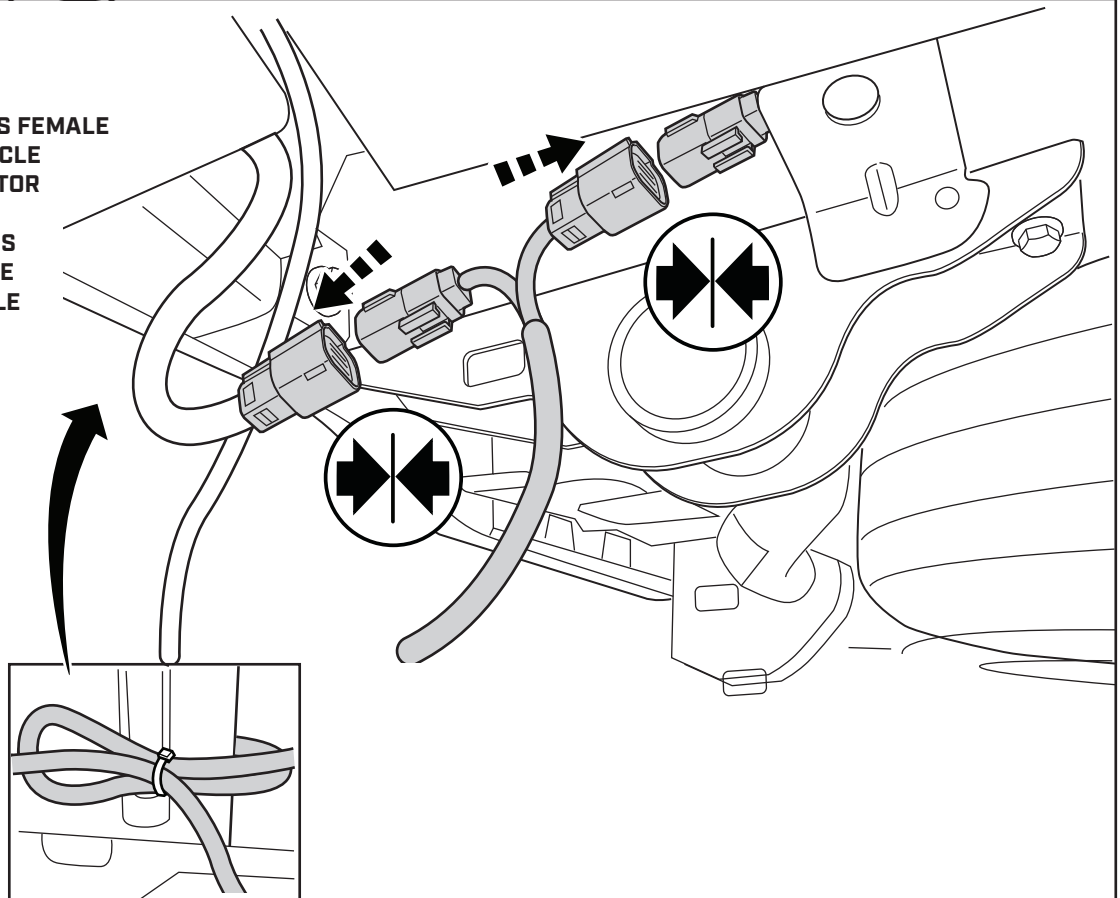

BUNDLE THE EXTRA T-HARNESS LENGTH UNDER THE VEHICLE AND SECURE WITH CABLE TIES.

STEP 42

SECURE THE GROUND WIRE ON THE T-HARNESS TO THE CHASSIS AT A SUITABLE LOCATION UNDER THE VEHICLE

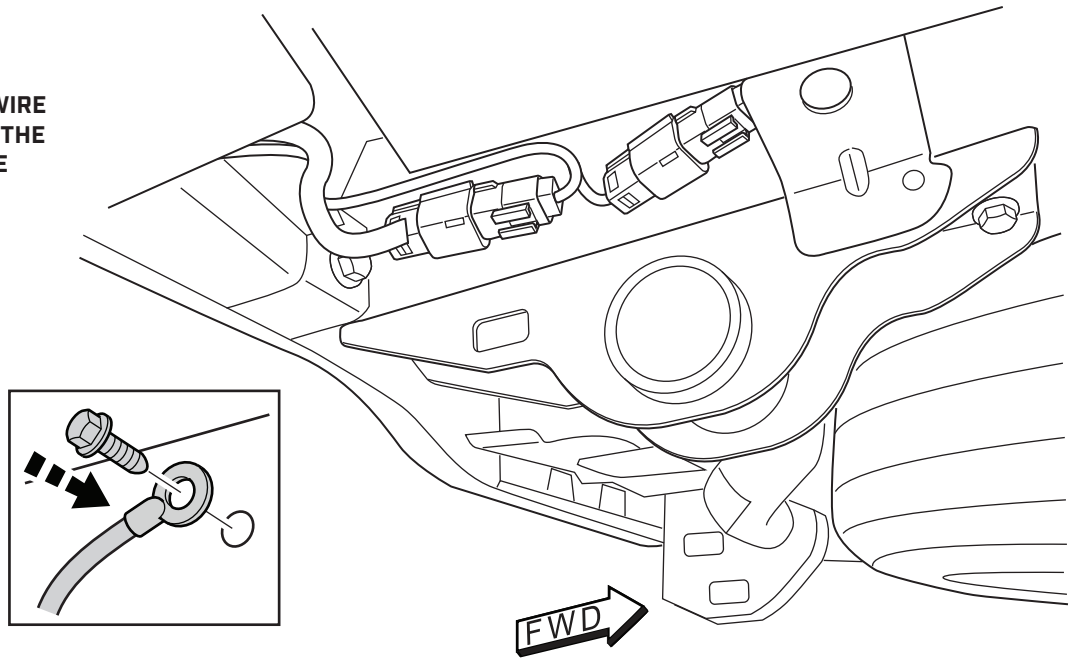

STEP 43

START THE TRUCK. NOTE THAT ON SOME MODELS, IT MAY TAKE UP TO 30 SECONDS FOR THE VEHICLE TO DETECT THE NEW CONNECTION. CHECK THE BRAKE LIGHTS AND TURN SIGNALS TO BE SURE THEY ARE FUNCTIONING PROPERLY.

ONCE YOU HAVE CONFIRMED THAT THE LIGHTS ARE WORKING CORRECTLY, SECURE THE HARNESS WITH CABLE TIES. **BE SURE NOT TO INTERFERE WITH ANY MOVING PARTS ON THE VEHICLE.**



THANKS FOR YOUR PURCHASE.
PLEASE LET US KNOW IF YOU HAVE ANY QUESTIONS.

SMARTCAP.COM - SUPPORT.NA@SMARTCAP.COM - NORTH AMERICA

